

# ADJUSTABLE BASE SHOE II INSTALLATION GUIDE

---

This guide offers helpful tips and step-by-step instructions for installing your Glassupply Adjustable Base Shoe System.

Refer to the end of the guide for close-up pictures of each step.

## THE TOOLS YOU'LL NEED

Below is a summary of the basic tools you'll need. In addition you'll find what tools to use for each product in the following step-by-step instructions. It is suggested to wear safety glasses when using power tools.

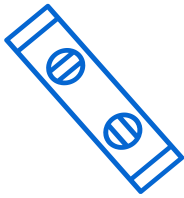

**LEVEL**



**ALLEN KEY**

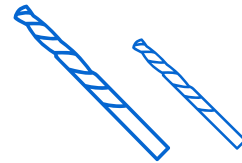

**DRILL BITS**

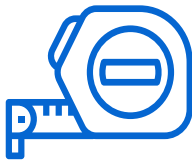

**MEASURING  
TAPE**



**PENCIL**

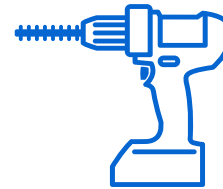

**POWER DRILL**



**MITER SAW**

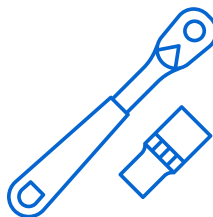

**RATCHET WITH  
EXTENSION**

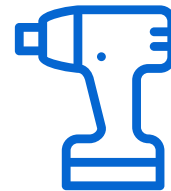

**IMPACT DRIVER**

# INSTALLATION STEPS

1

## POSITION AND MARK THE BASE SHOE PROFILE

- ✓ **POSITION THE PROFILE:** Align the profile with the centerline mark and place it in its final position on the floor.
- ✓ **MARK THE HOLES:** Use the pre-drilled holes in the profile as guides. Insert a marker or pencil into each hole and mark the floor.
- ✓ **CHECK MARKS:** Remove the profile and ensure all marks are clear and accurate.

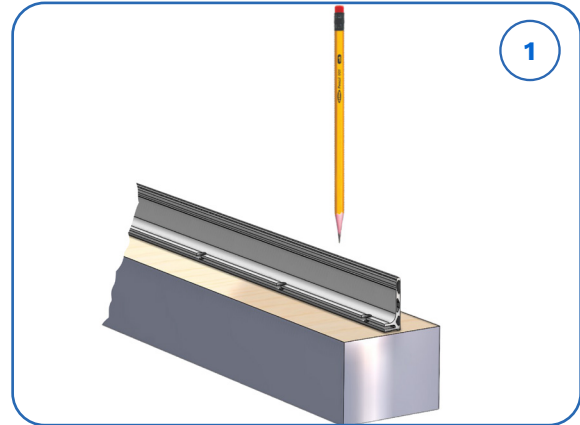

2

## MARK AND DRILL DRAINAGE HOLES

- ✓ **FOR OUTDOOR INSTALLATIONS:** Manually drill drainage holes every 600mm (approximately 24" inches) along the profile to allow proper drainage.



2.1

## DRILL PILOT HOLES INTO SUBSTRATE

- ✓ **PROCEED WITH DRILLING:** Drill Pilot holes into the floor at the marked spots in step 1 to prepare for installation.

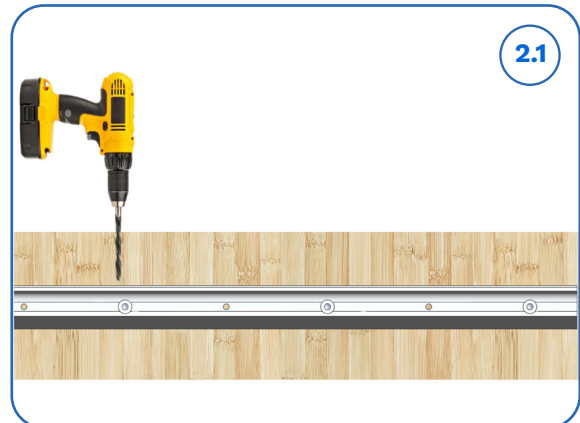

3

## LEVEL BASE SHOE EXTRUSION

- ✓ **ENSURE THE PROFILE IS LEVEL:** Although the adjustable system allows for glass tilting adjustment, it is recommended to keep the base as level as possible to facilitate the installation process. Shims must be placed at the location of the fastener if the base needs to be leveled.
- 💡 Shims also add stability and support to enhance the overall sturdiness of the railing once the glass is installed, preventing the base from slightly tilting.
- ✓ If you're dealing with a significantly uneven surface like the one shown in Image 2 of Step 3, correct it by sanding or removing excess material until both sides of the base sit stable on the surface.

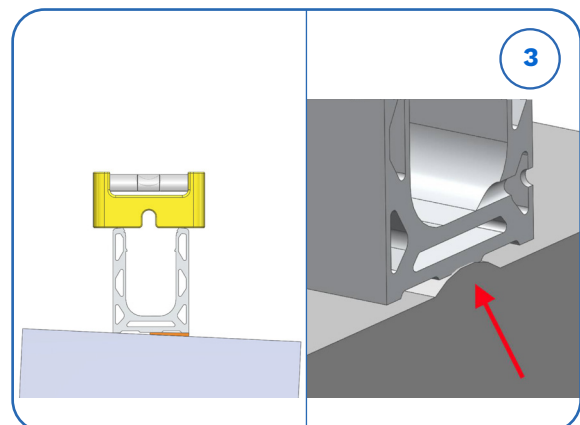

### 3.1 ANCHOR THE BASE IN PLACE

- ✓ **SECURE THE BASE USING THE APPROPRIATE ANCHORS:** Start by using a power drill for most of the screwing, then finish by tightening with a manual wrench to ensure the correct torque.

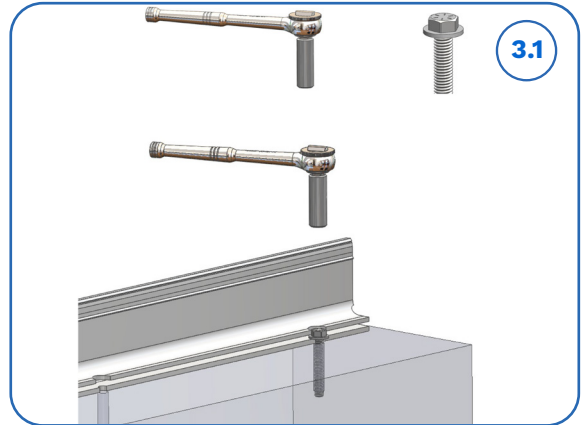

### 4 INSTALL ALIGNMENT PINS

- ✓ Install alignment pins in the bottom hole section.
- ✓ Use a rubber hammer to secure the pins in place.

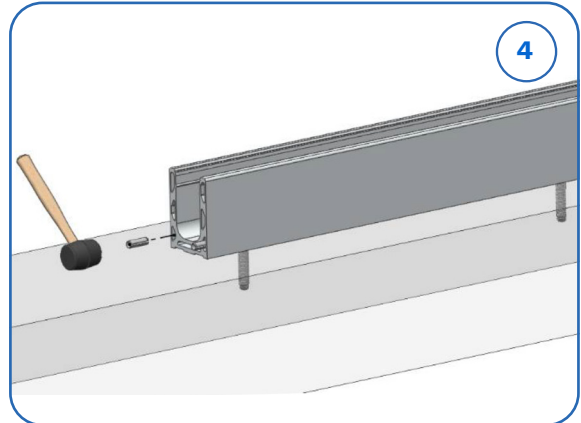

### 4.1 ALIGN BASE SHOE PROFILE

- ✓ Use the rubber hammer to join the profiles together.
- ✓ Align both profiles, leaving a 2-3 mm expansion gap for thermal expansion in outdoor installations.

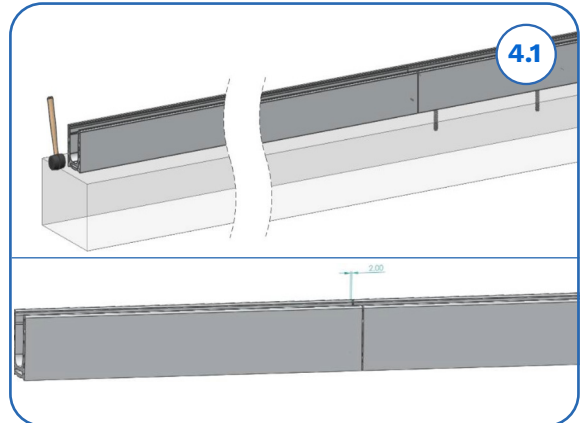

### 5 CALCULATING THE NUMBER OF ADJUSTABLE CLAMPS NEEDED

- ✓ **FOR FRAMELESS SYSTEM** (no clamps or top rail required):  
To calculate the number of clamps needed, use this formula:  
1 adjustable clamp per foot (rounded down), with a minimum of 3 clamps required (for span over 2 feet).

**EXAMPLE:** For a Span length that is 5.5 feet:  
Apply the formula: 1 clamp per foot x 5.5 feet = 5.5 clamps.  
Round down to 5 clamps. Since the minimum requirement is 2 clamps, you would need 5 clamps for a 5.5-foot railing span.

- ✓ **WITH CLAMPS OR TOP RAIL:** (To calculate the number of clamps needed, use this formula: 0.9 adjustable clamp per foot (rounded down), with a minimum of 3 clamps required. (for span over 2 feet).

**EXAMPLE:** For a Span length that is 5.5 feet:  
Apply the formula: 0.9 clamp per foot x 5.5 feet = 4.95 clamps.  
Round down to 4 clamps. Since the minimum requirement is 3 clamps, you would need 4 clamps for a 5.5-foot railing span.

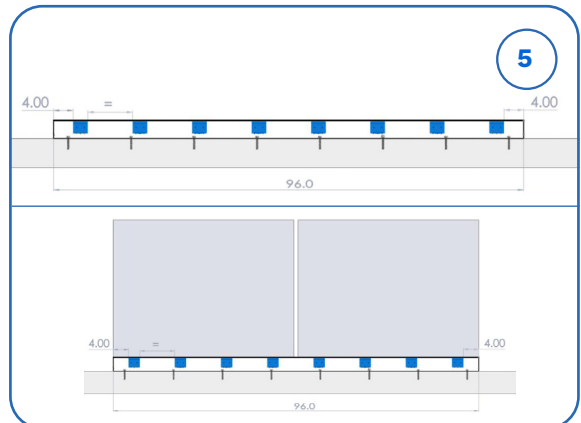

### 5.1 INSTALL ADJUSTABLE CLAMPING DEVICE

- ✓ Install the first 2 clamps 4" (100mm) from both end edges of the base shoe profile.
  - ✓ Evenly space additional clamping devices apart along the glass width.
  - ✓ Push the adjustable clamp down the base until it snaps into place.
  - ✓ Double-check that the adjustable moving side of the clamp is set to its fully open position.
- 💡 Each side of the face has an ultra-thin double-sided tape strip. Peel off the protective film before snapping the clamp into place.

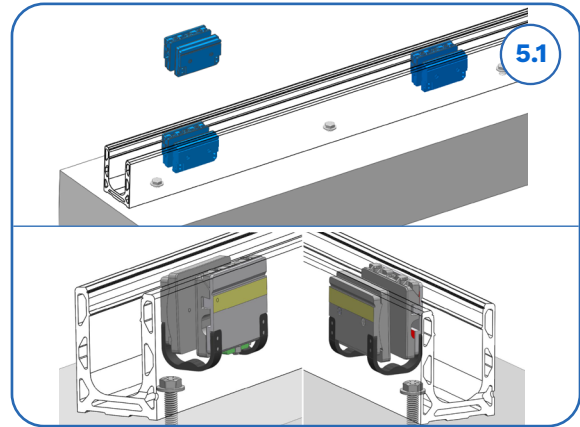

### 6 APPLY DOUBLE-FACED TAPE TO CLADDING

- ✓ Clean the profile to ensure a good bond.
- ✓ Apply the double-faced tape from the installation kit to the bottom section of the cladding's inside face.

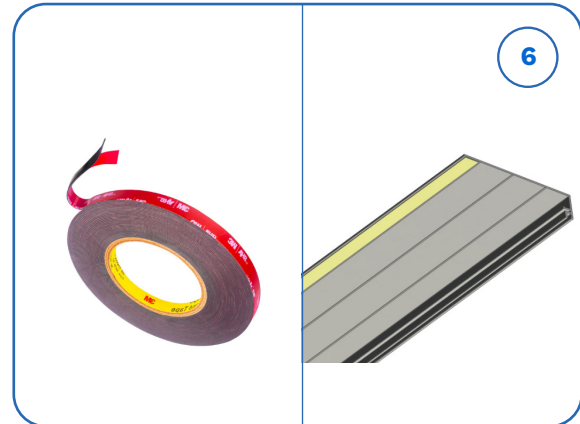

### 6.1 INSTALL OUTSIDE GASKET ON CLADDING

- ✓ Attach the outside gasket to the cladding profile. You can either press it into place or slide it along the extrusion from the side.

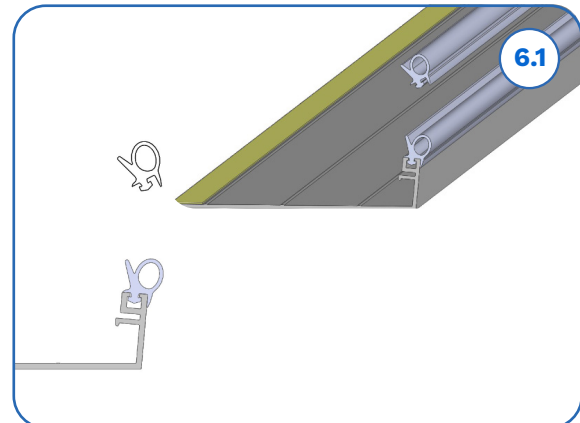

### 6.2 OUTSIDE CLADDING INSTALLATION ON THE BASE SHOE

- ✓ Position the cladding at an angle so that the hook engages with the base shoe groove.
- ✓ Tilt the cladding into place until it is straight.
- ✓ If necessary, gently tap the top of the cladding with a rubber hammer to ensure all sections snap securely along the profile.
- ✓ Apply pressure at the bottom to ensure the double-face tape bonds both parts together.



## 7 SET THE GLASS IN PLACE

- ✓ Carefully drop the glass into position from the top of the base shoe opening.

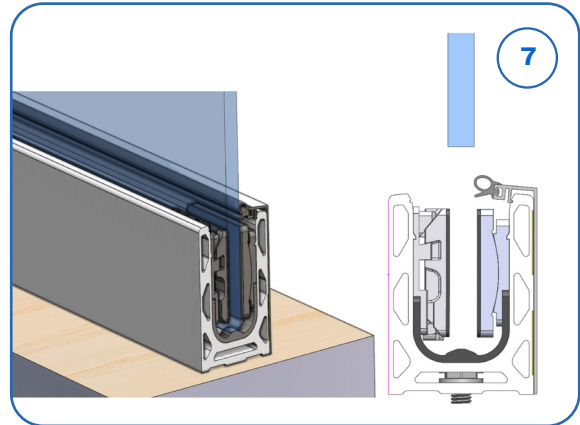

## 8 ADJUSTABLE CLAMP TIGHTENING AND ADJUSTMENT

- ✓ The two side screws control the top part of the movable face. Each screw moves its respective wedge downward, pushing the top of the clamp face against the glass. The side screws will cause the top of the glass to tilt outwards.
- ✓ The middle screw moves the face in the opposite direction, pushing the lower part of the clamp face forward. The middle screw will cause the top of the glass to tilt inwards.
- ✓ Alternate between tightening the middle screw and the side screws until the clamp securely holds the glass.

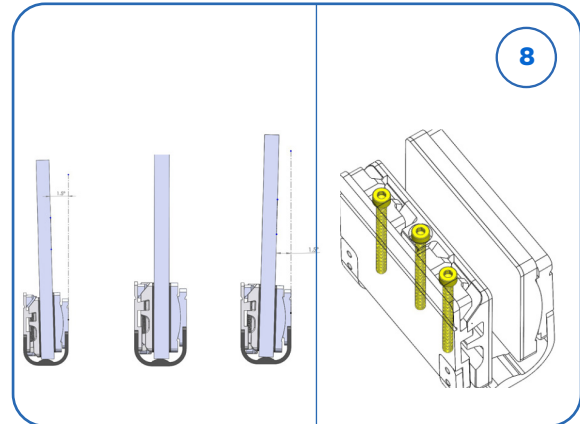

## 8.1 ADJUSTABLE CLAMP STRAIGHT INSTALLATION

- ✓ To install the glass straight, use a level while the clamps are still slightly loose. While keeping the glass level, tighten by alternating between the side screws and the middle screw to ensure a secure, straight position.
- ✓ Begin by tightening the clamps at both ends of the glass first, then finish with the clamps in the middle.
- ✓ The glass can be adjusted by  $\pm 1.5$  degrees, which equates to about a 1-inch difference at the top of the glass.

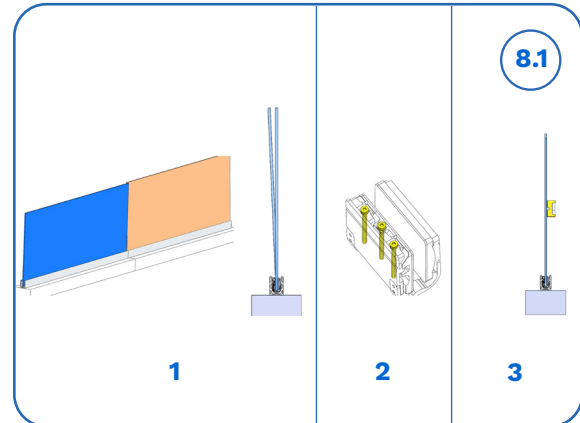

## 9 GLASS HEIGHT ADJUSTMENT

- ✓ If the top of the glass needs slight adjustment to align perfectly with the adjacent panel, use small rubber shims to make the necessary adjustments.
- ✓ When installed in a continuous base, the glass height should generally be close to self-aligning.

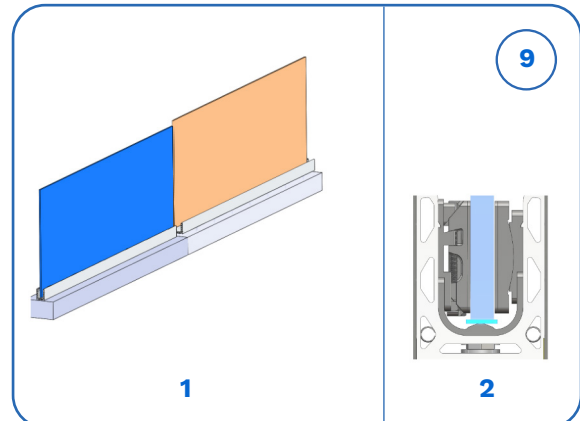

**10 INSIDE CLADDING INSTALLATION**

- ✓ Repeat step 6 and 6.2

**11 INSIDE GASKET PUSH IN INSTALLATION**

- ✓ Push the gasket from the top until it sets into place, fitting the bottom leg first and then the top.

**12 END CAP INSTALLATION**

- ✓ Apply double-sided tape to the cover as indicated.
- ✓ Press the cover firmly against the profile to secure the tape and join both parts together.
- ✓ Alternatively, you can use silicone for a more permanent bond.

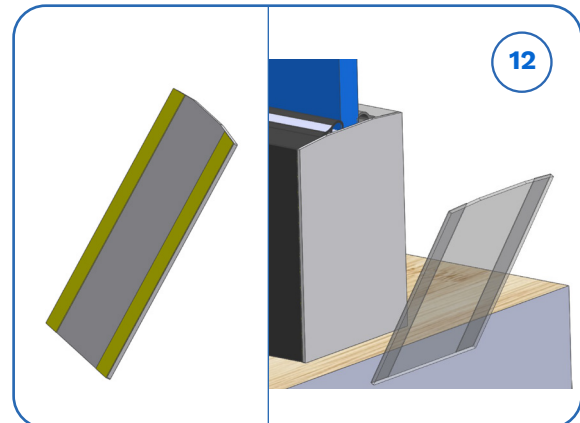
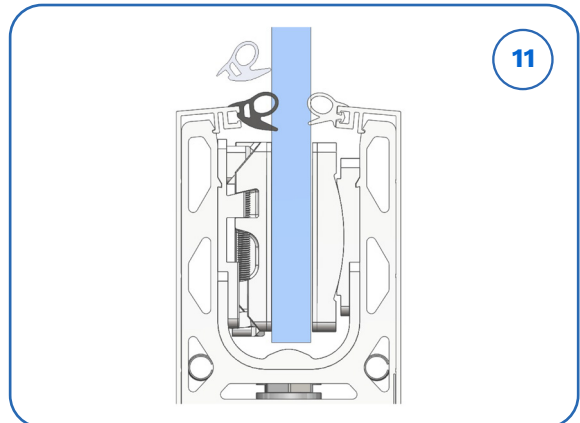
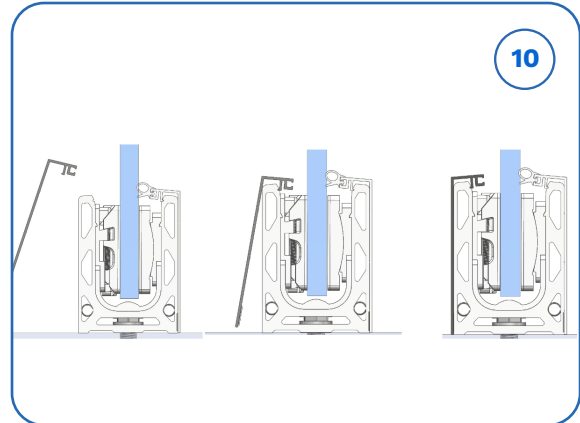

1

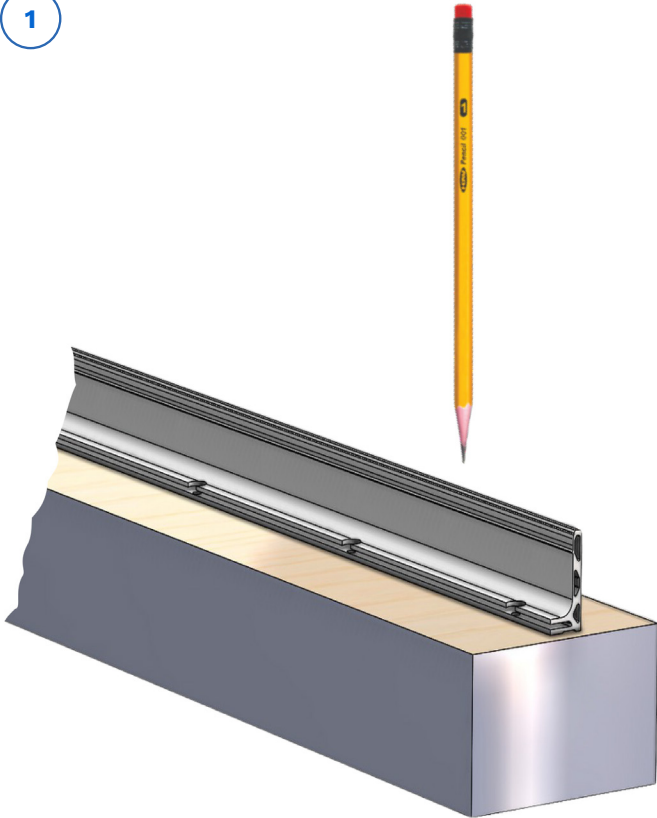

2



2.1



3

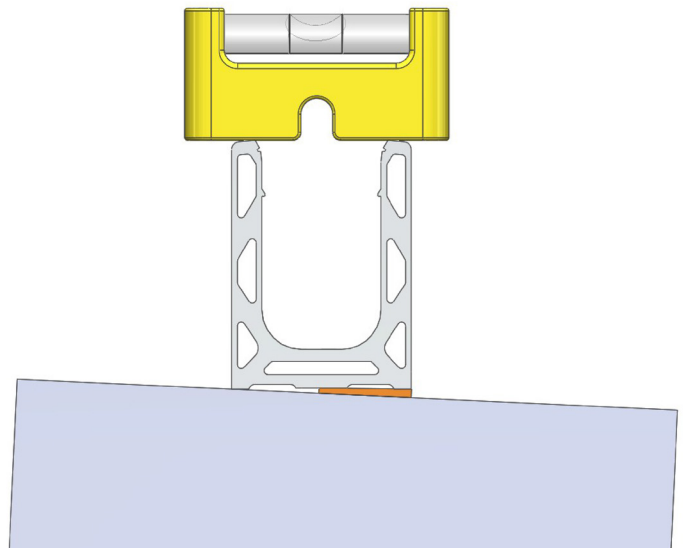

3

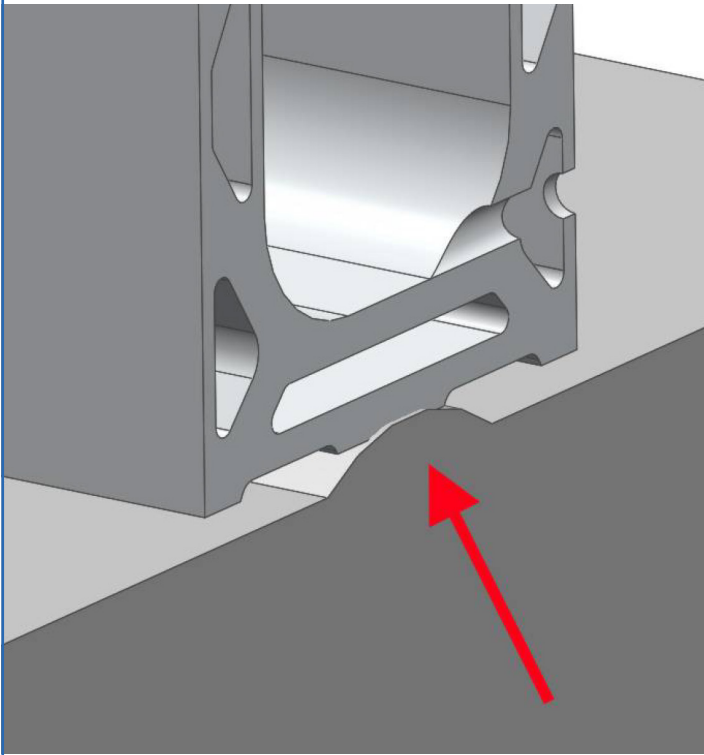

3.1

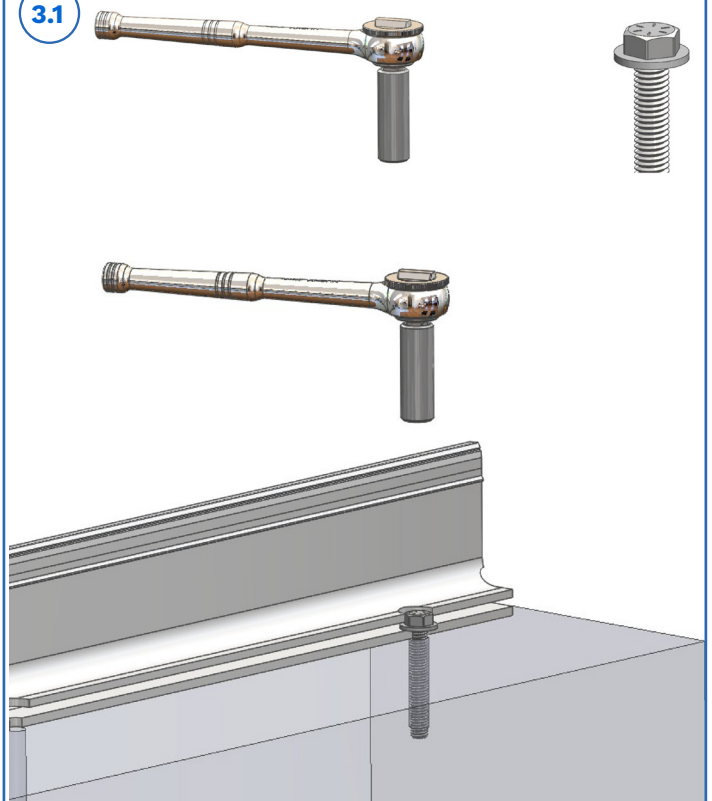

4

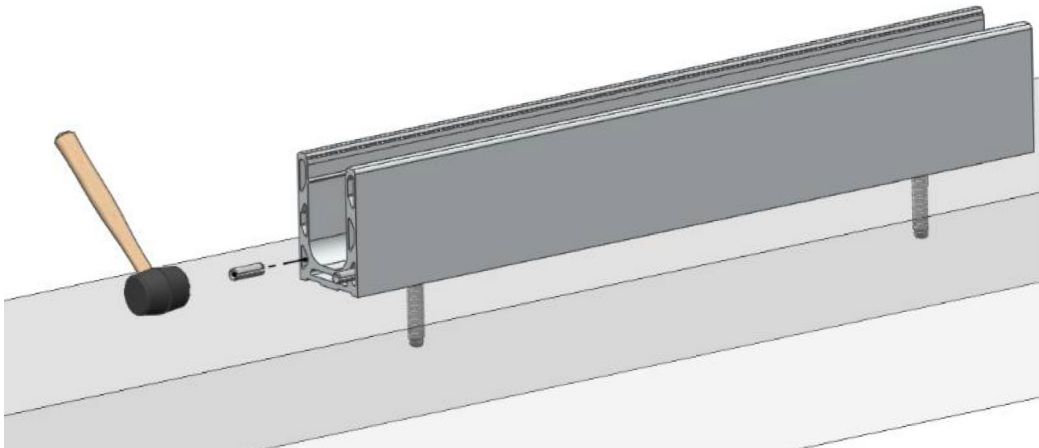

4.1

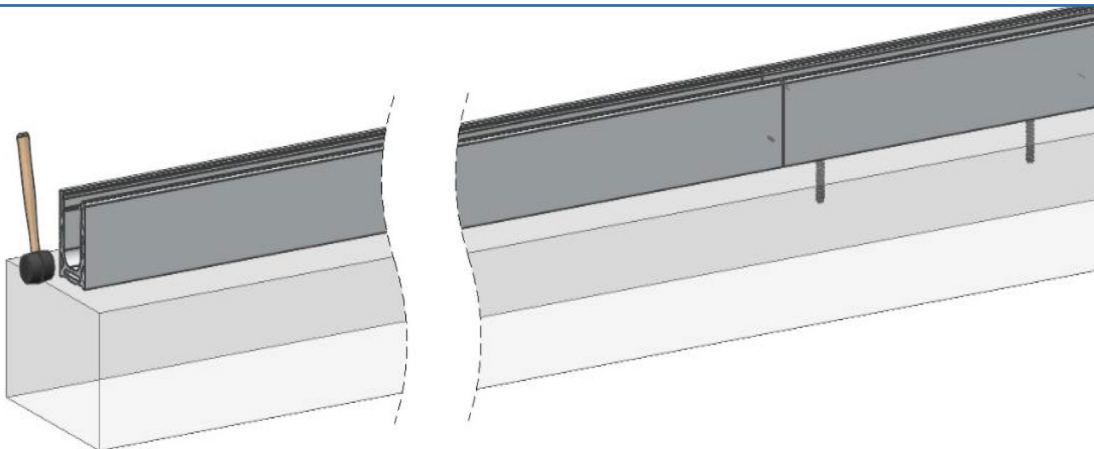

4.1

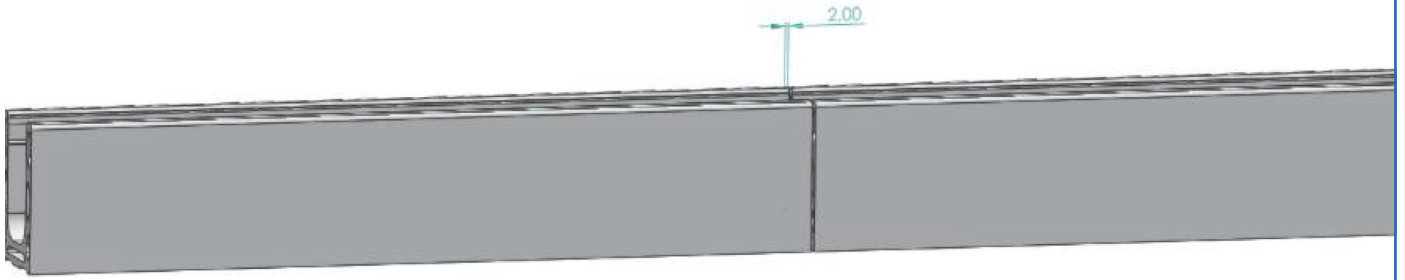

5

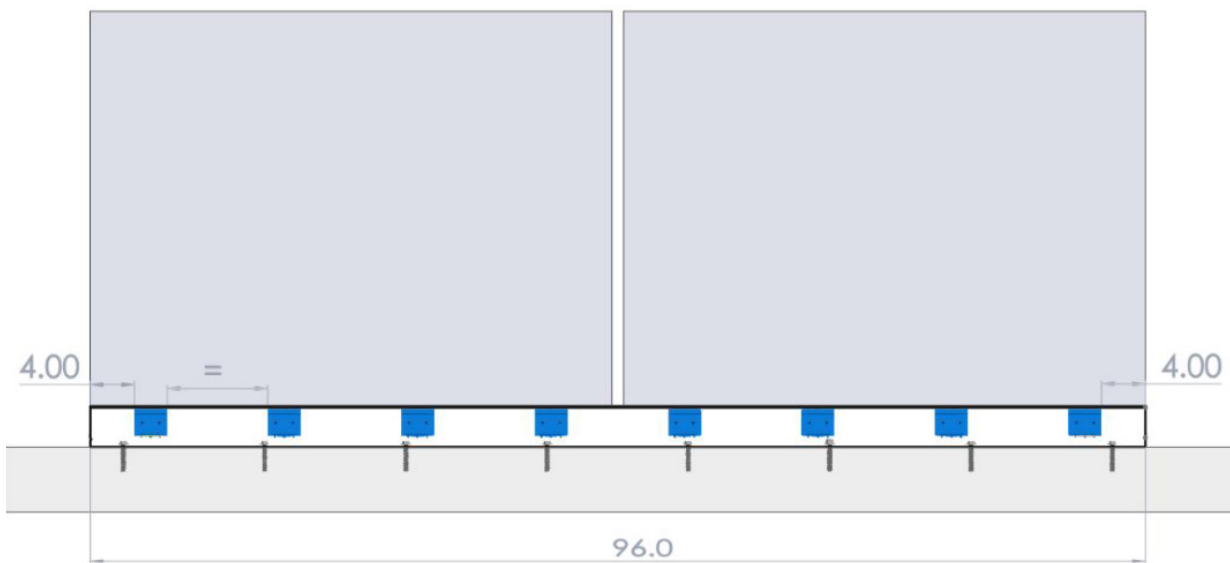
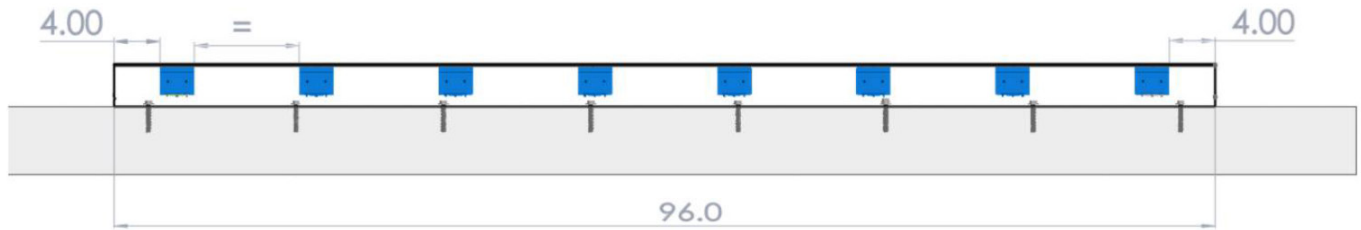

5.1

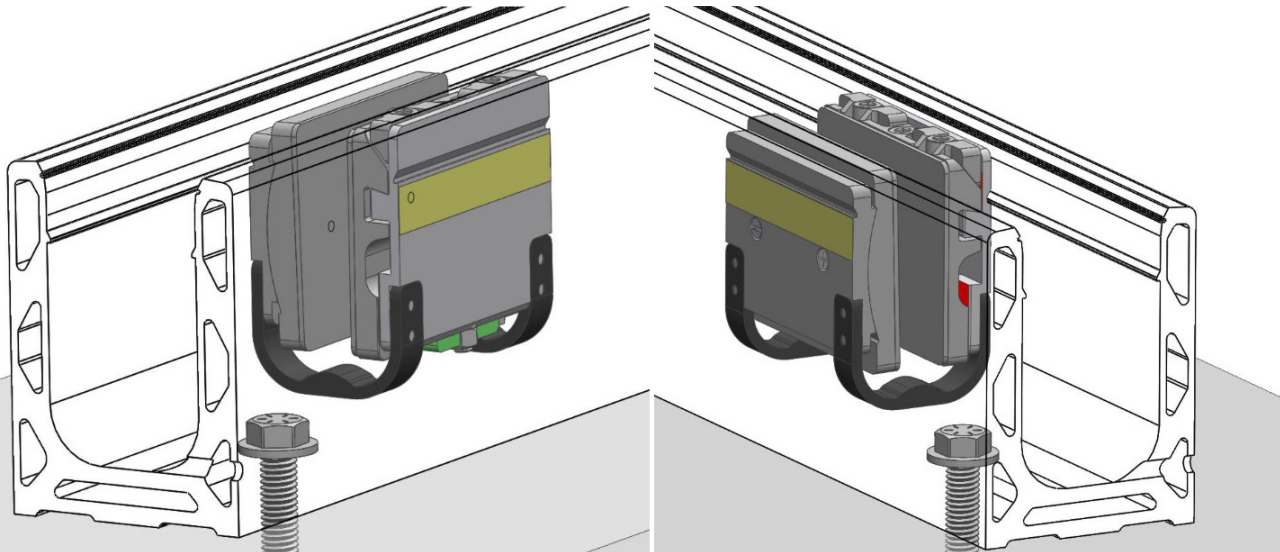
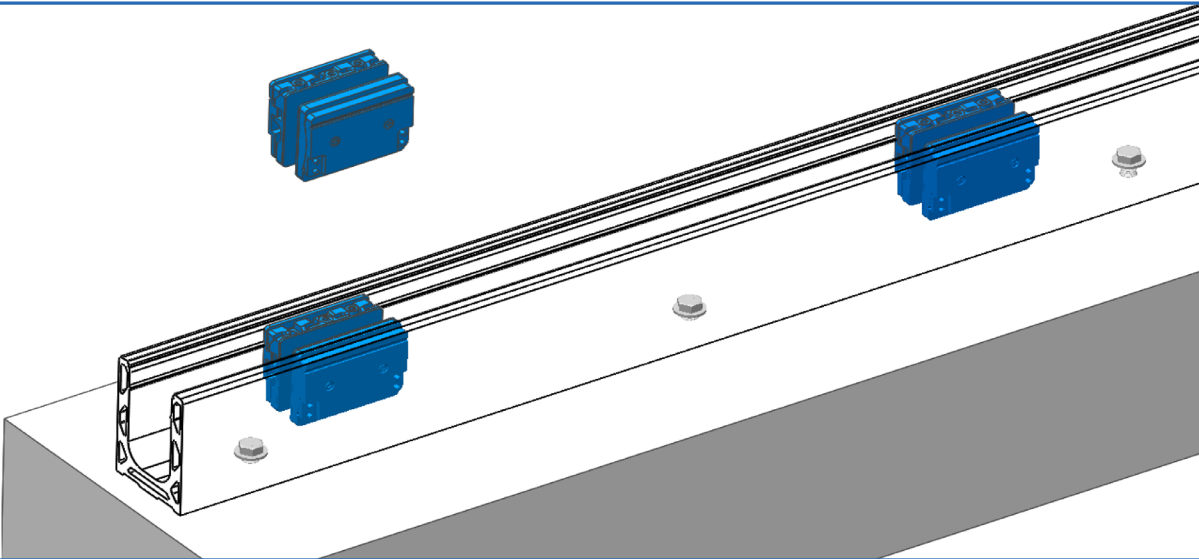

6

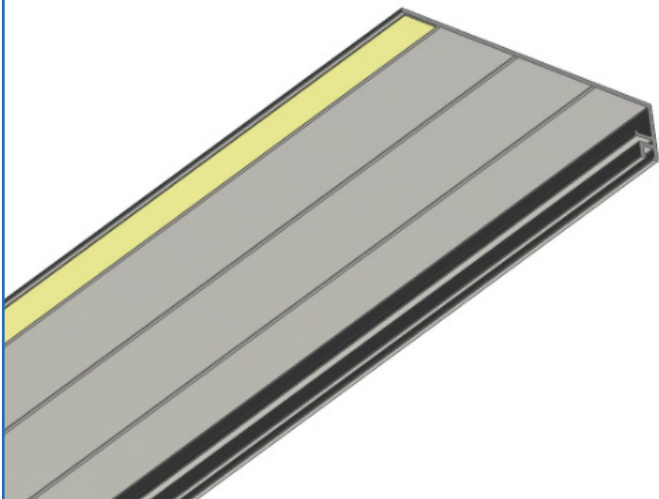

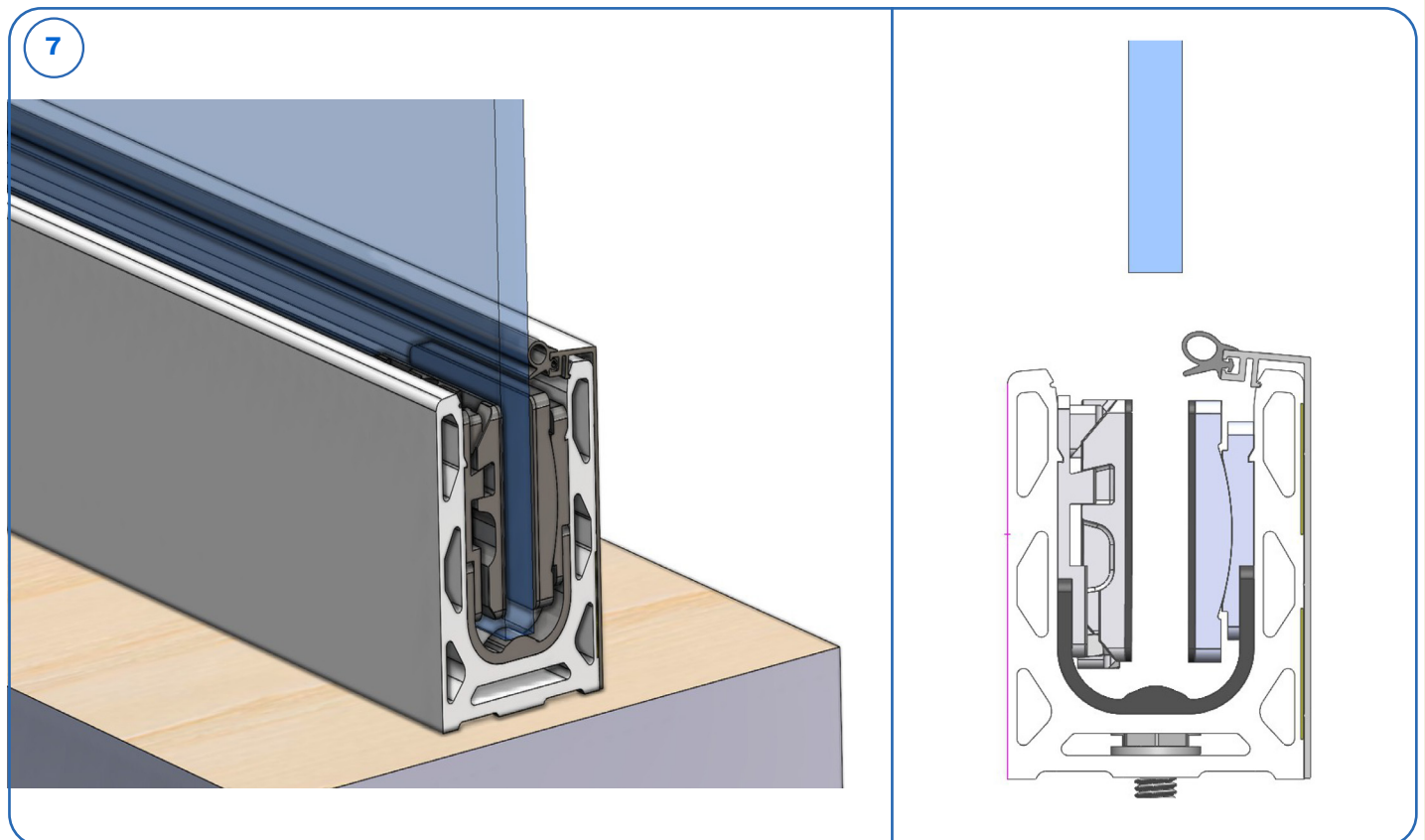
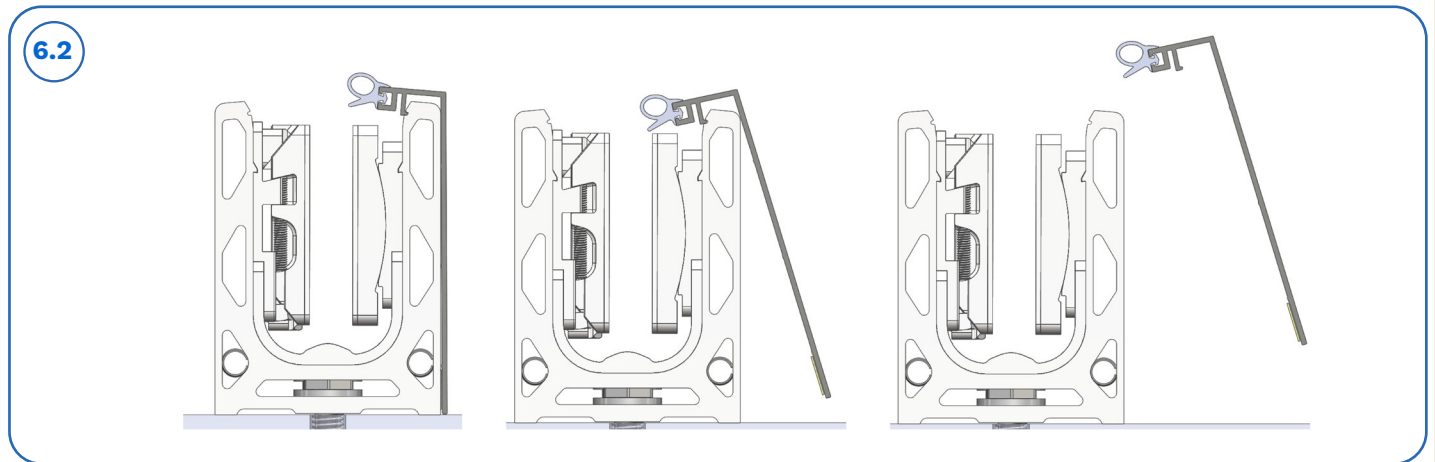
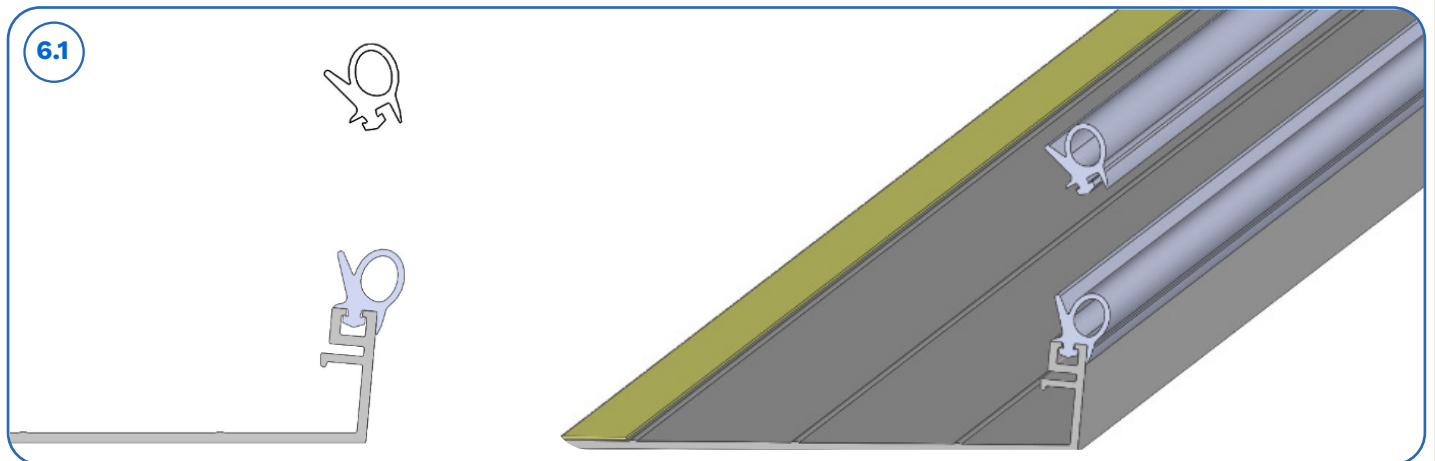

8

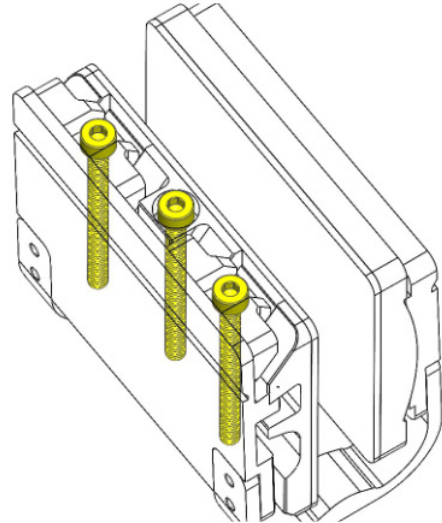
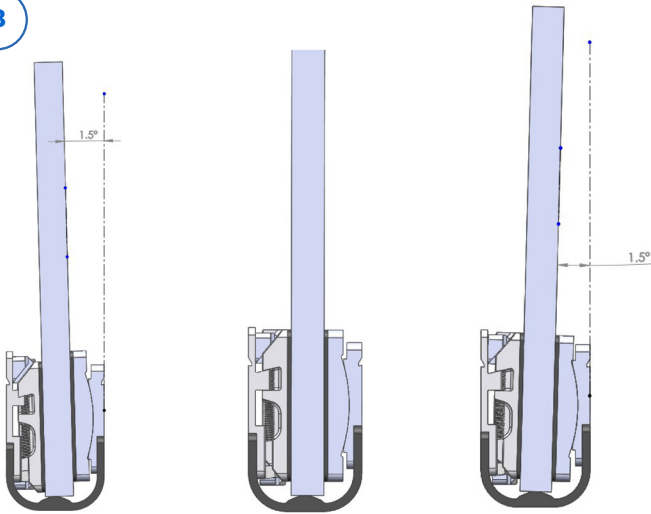

8.1

1

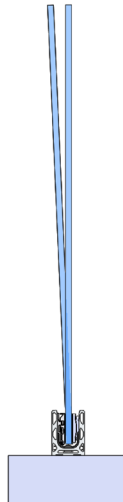
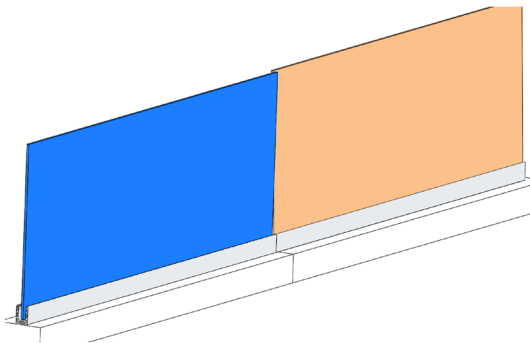

2

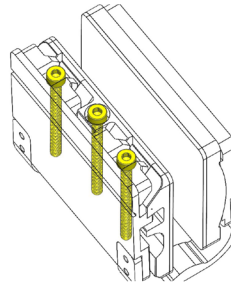

3

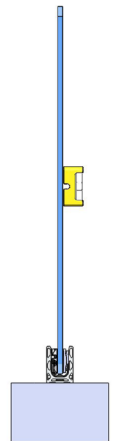

9

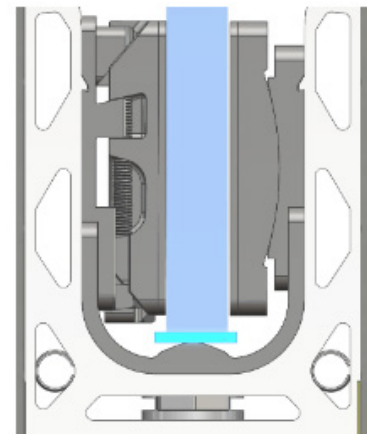
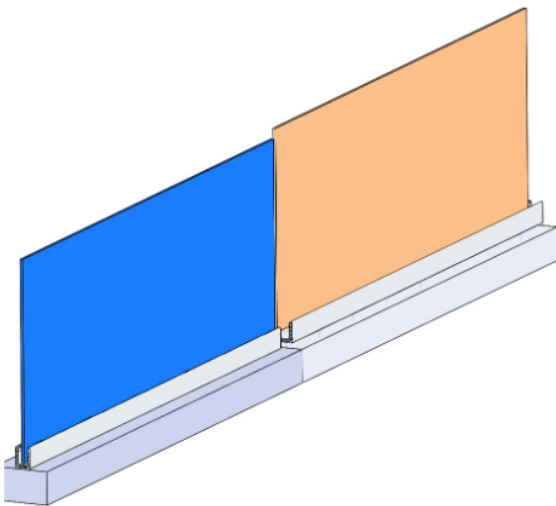

10

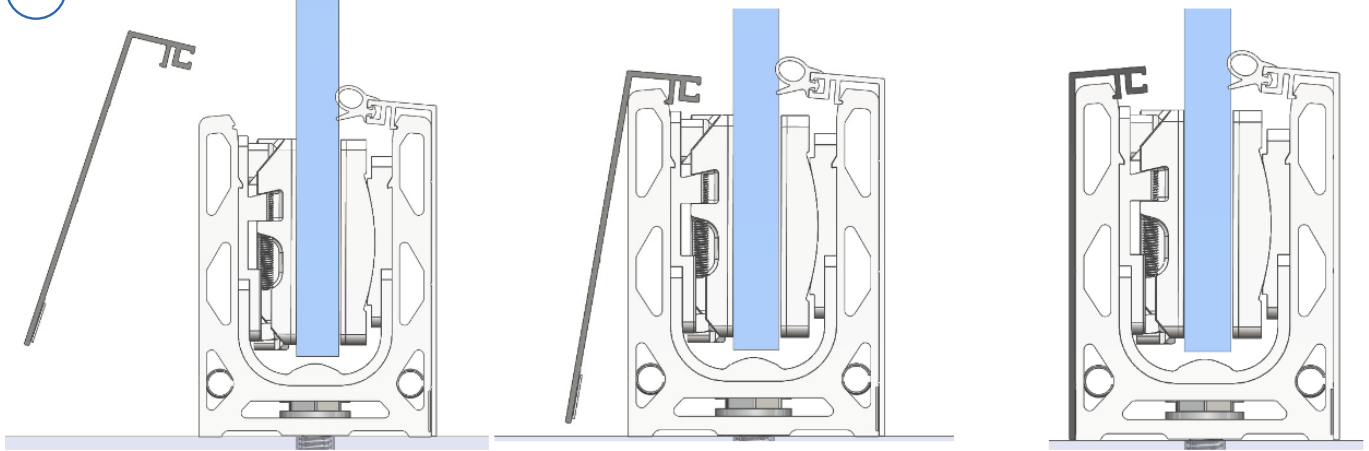

11

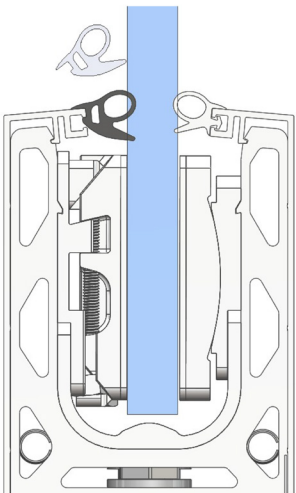

12

