

ALUMINUM FRAMED GLASS RAILING INSTALLATION GUIDE

This guide offers helpful tips and step-by-step instructions for installing your Glassupply Aluminum Framed Glass Railing System

Please note: Detailed, zoomed-in pictures of each step are available at the end of this guide.

THE TOOLS YOU'LL NEED

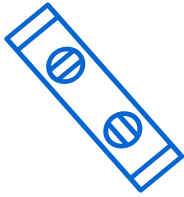

LEVEL

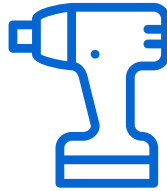

IMPACT DRIVER

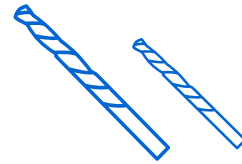

DRILL BITS

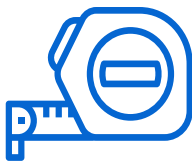

**MEASURING
TAPE**



PENCIL

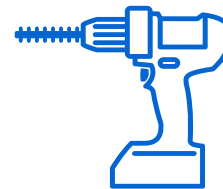

POWER DRILL



MITER SAW

INSTALLATION STEPS

1 MARK POST HEIGHT

- ✓ Use the provided cutting template guide to mark the final height of your post system. The final post height is indicated in column B for each predefined railing height.

💡 The plastic guide will also be used to mark the post bracket in later steps.

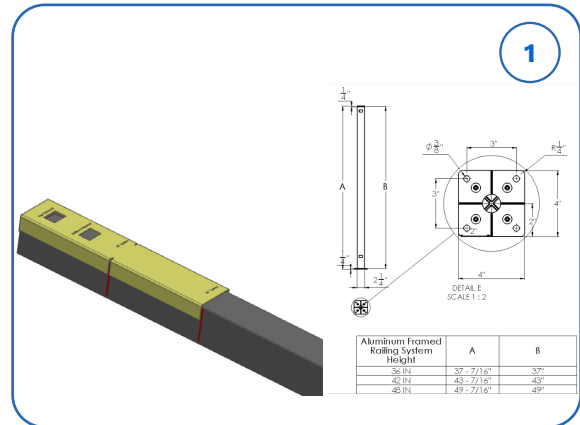

1.1 CUT POST

- ✓ Cut the post to the final height using a miter saw or hand saw.

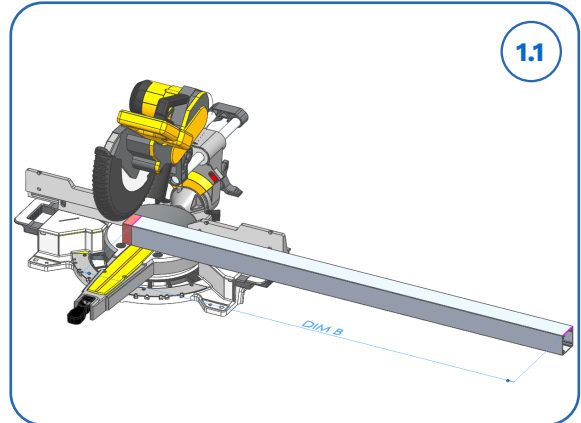

2 INSERT GASKET TO TRACKS

- ✓ Insert and snap the gasket into both the top and bottom tracks

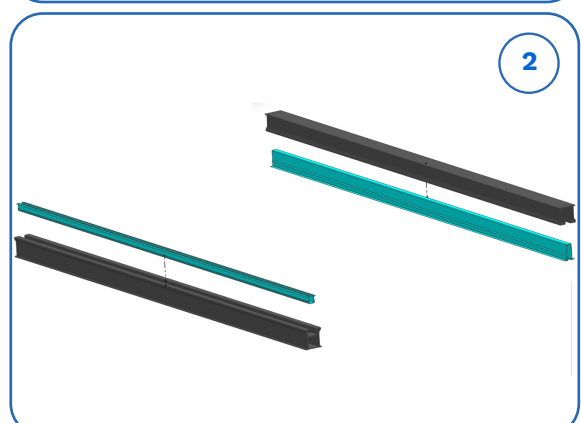

2.1 CUT TOP AND BOTTOM TRACKS

- ✓ Trim both the top and bottom tracks to their final width. Use the provided to-scale plan to determine the exact dimensions, as each order is custom-made for a precise fit.

💡 e.g, in the image shown, the final track width will be 62"

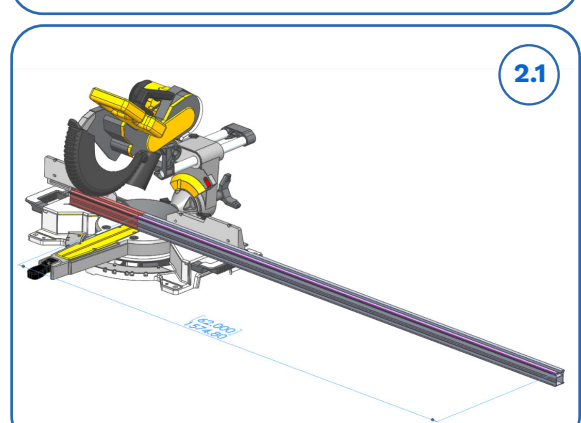

3 MARK AND SECURE TOP POST BRACKET

- ✓ Use the provided template to mark the final post bracket position, and secure it using self-tapping screws (Part No. R-AFR-HRSCW8-0.5-00).
- 💡 The upper edge of the top bracket should be positioned 15/16" below the top of the post.

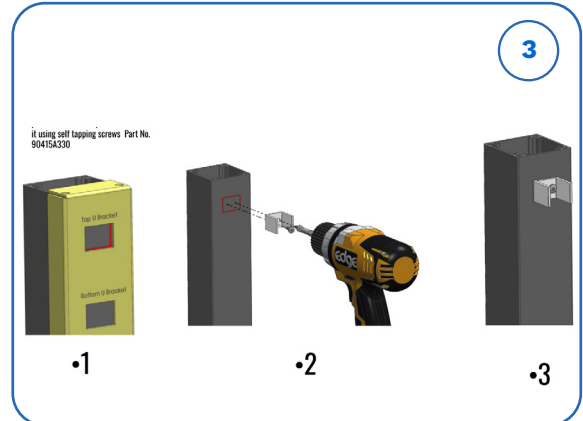

3.1 MARK AND SECURE BOTTOM BRACKET

- ✓ Repeat Step 3 procedure to mark the bottom bracket position, secure it with self-tapping screws (Part No. R-AFR-HRSCW8-0.5-00)
- 💡 The upper edge of the bottom bracket should be positioned 4" from the bottom of the post.

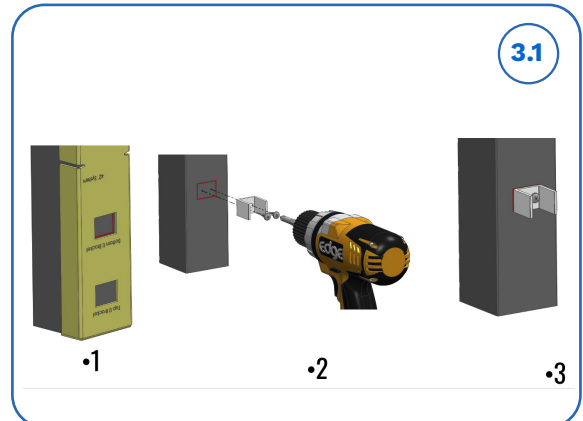

3.2 VERIFY POST BRACKET INSTALLATION

- ✓ After completing Step 3, the final post assembly of each post type should match the results shown in the pictures 3.2

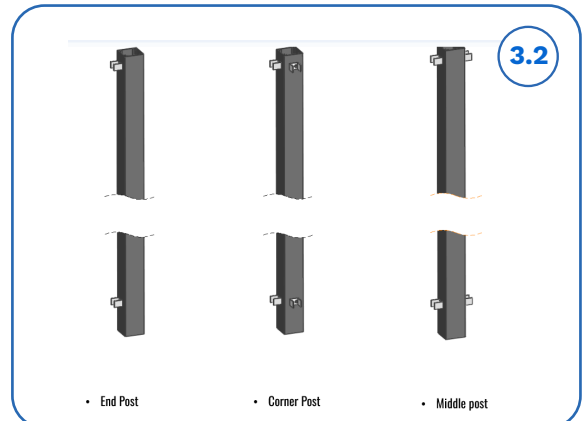

4 INSTALL POST PLATE TO POST BOTTOM

- ✓ Align the post plate with the bottom of the post, ensuring the holes on both parts are properly aligned. Using a power drill and self-tapping screws (Part No. R-AFR-PBSCW14-2-00), securely fasten the post plate to the post bottom. Tighten all screws to ensure a stable connection.

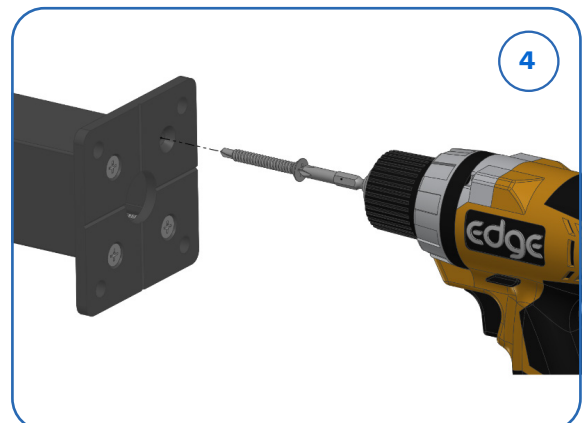

4.1 VERIFY POST BASE INSTALLATION

- ✓ After installing the post base, the post should look as shown in the images 4.1. Ensure the base is firmly attached to the bottom of the post.

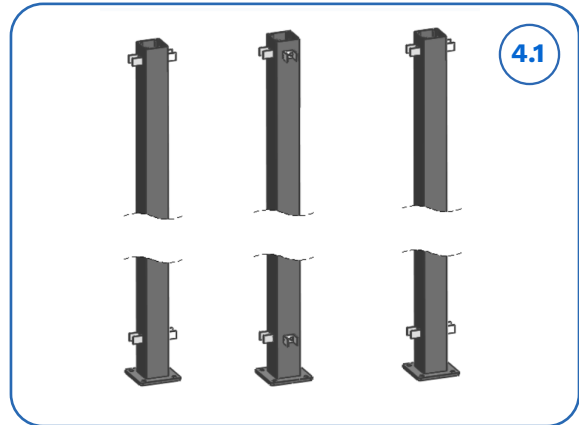

5 ATTACH TOP TRACK TO POST

- ✓ Insert the top track over the U bracket and secure it in place using self-tapping screws (Part No. R-AFR-HRSCW8-0.5-00). Use 4 screws per Bracket (2 per sides) The profile grooves are designed to help guide screw spacing for accurate installation.

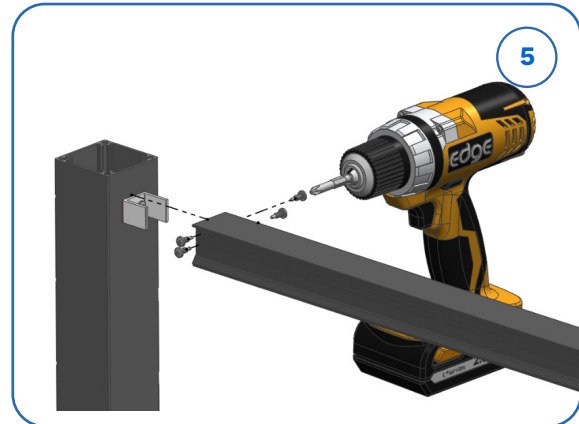

5.1 ATTACH BOTTOM TRACK TO POST

- ✓ Repeat the process from Step 5, this time attaching the bottom track to the bottom bracket, ensuring it is secured in place using self-tapping screws.

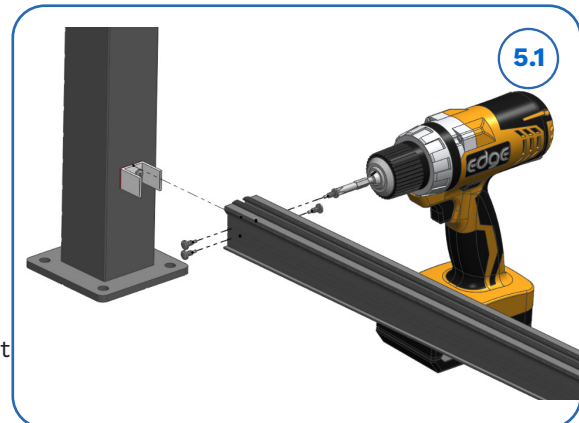

5.2 VERIFY PARTIAL FRAME ASSEMBLY

- ✓ After completing the previous steps, the partial frame should look like the examples shown for each post type: End Post, Corner Post, and Middle Post

6 MARK THE CENTERLINE OF THE RAILING

- ✓ Mark the centerline of the railing on the substrate. Using a chalk line is recommended for accuracy. A distance of around 3.5" from the edge is suggested, but adjust as needed based on your specific installation.

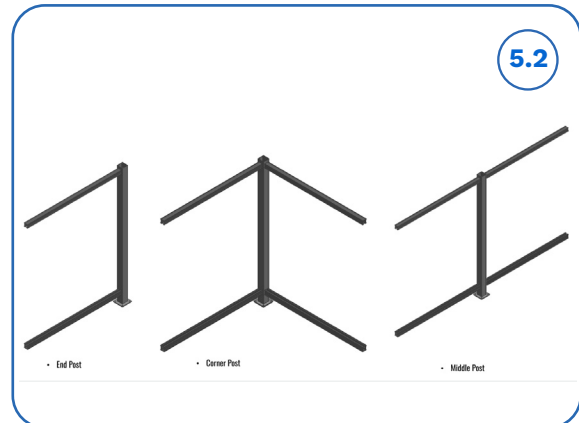
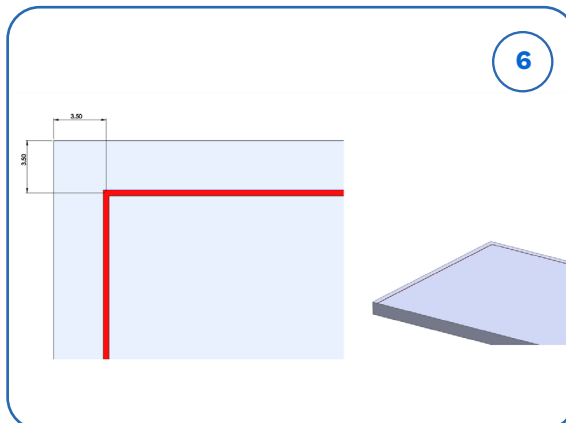

6.1

ALIGN POST WITH MARKED CENTERLINE

- ✓ Position the post so that it aligns with the previously marked centerline on the substrate. For example, in this illustration, the corner post is shown. Follow the same process for all posts to ensure proper alignment in the layout.

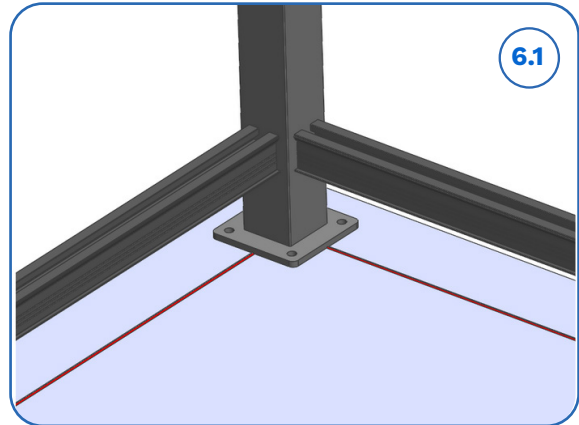

7

ADD SUBSEQUENT POST

- ✓ Install the next post in the sequence. Ensure it is square and use the same self-tapping screws as in Step 5 to secure it in place.

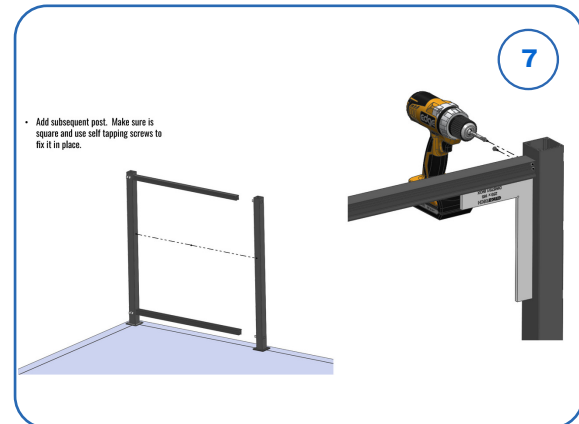

7.1

ADD SUBSEQUENT RAILS

- ✓ Install the next set of rails as shown. Make sure they are square and secure them in place with screws. Repeat Step 7 and 7.1 for each additional section.

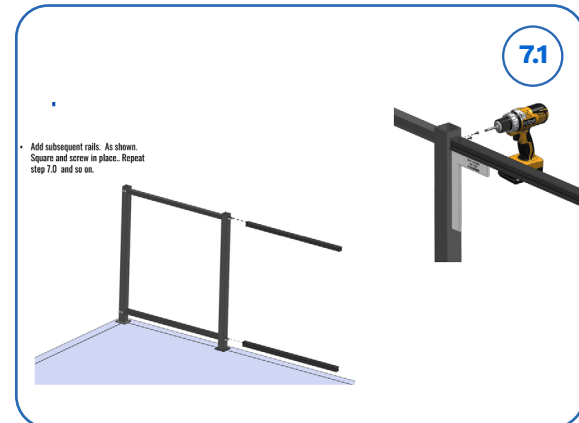

7.2

TEMPORARILY SECURE POST

- ✓ You can add a temporary screw to every other post to hold it in place while more frames are added. This step is especially helpful when installing at heights.
- 💡 This is a temporary step to help with stability as you continue adding the rest of the structure.

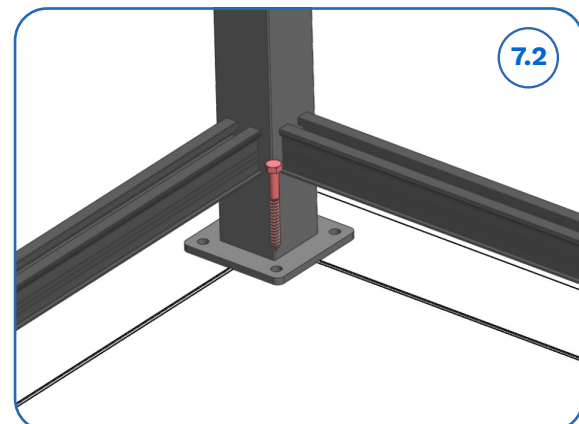

7.3 COMPLETING FRAMEWORK

- ✓ The framework and layout at this stage of the installation should resemble the example shown here. Note: This layout is provided for illustration purposes only. For longer spans, we recommend dividing the layout into smaller sections.

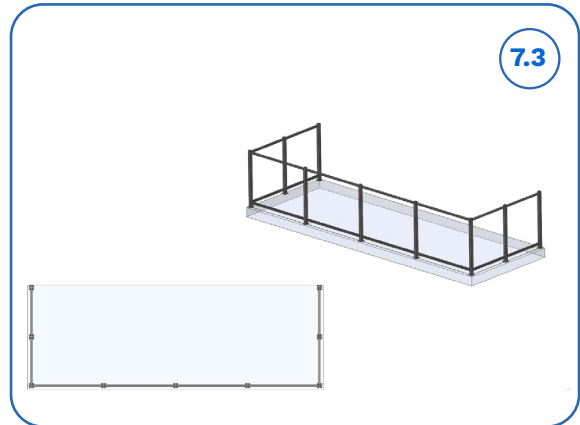

8 LEVEL POST

- ✓ Ensure the posts are properly leveled and plumb. Use small shims if necessary to achieve the correct positioning.

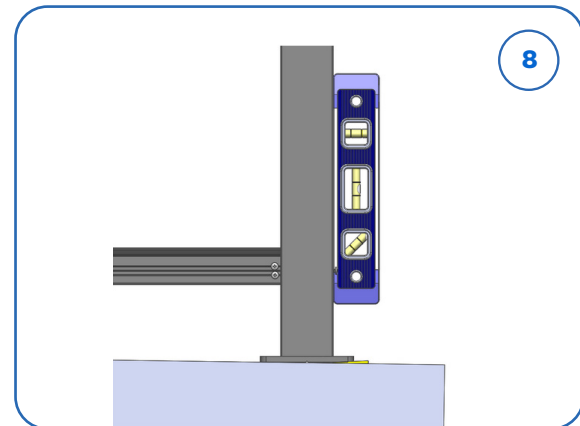

8.1 FASTEN POST BASE TO SUBSTRATE

- ✓ Secure the post base to the substrate by fastening all four lag screws. Ensure the post is properly aligned and firmly attached for maximum stability.

💡 We Provide in the installation kit 4x HEX-CAPS bolt covers per post, for a clean slick finish. Use lag bolts or lag screws with a 3/8" diameter across the flats, such as Hex-Washer head bolts, Flange Bolts, or Tapcon screws. Our HEX-CAPS bolt covers are specifically designed to fit these hex bolts, providing a clean, finished appearance. Made from high-impact plastic with a UV stabilizer additive, HEX-CAPS covers are suitable for both indoor and outdoor use.

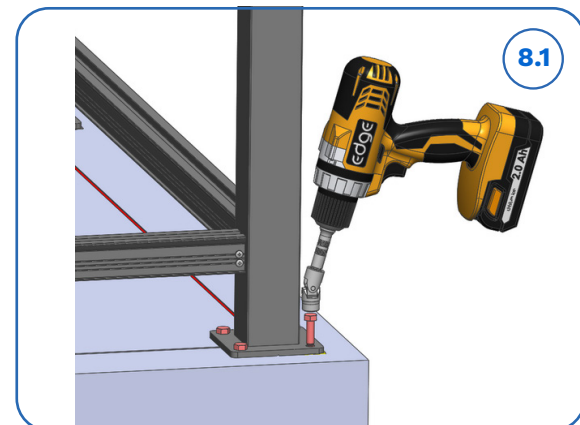

9 INSTALL HANDRAIL AND BOTTOM TRACK COVER

- ✓ **POSITION THE HANDRAIL:** Align the upper handrail above the top track, ensuring it is properly seated along the length of the frame.
- ✓ **SECURE WITH A RUBBER Mallet:** Use a rubber mallet to gently tap the handrail into place. Apply light, even hits across the length of the handrail to ensure it snaps securely into position.
- ✓ **CHECK FIT:** Once installed, verify that the handrail is firmly attached and aligned evenly with the top track.

Repeat Steps for the bottom track cover.

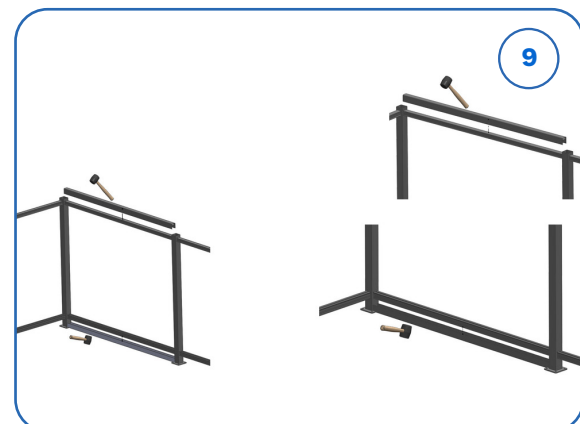

10 LUBRICATE GASKET FOR GLASS INSTALLATION

- Before installing the glass panel, apply a lubricant to the gasket along the bottom and top tracks. You can use a mixture of water and soap or a glass cleaning spray. This will reduce friction, making it easier to slide the glass into place during the next step. Ensure the gasket is evenly coated for the best results.

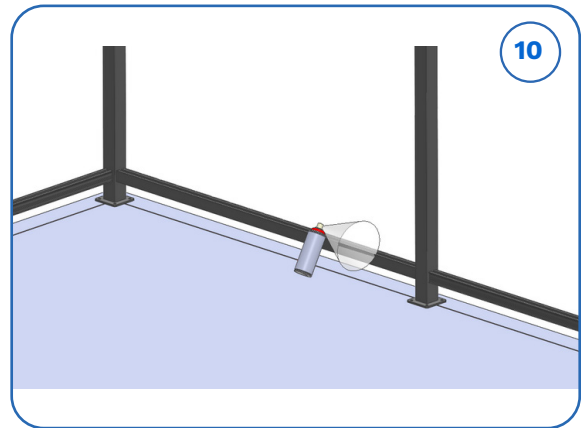

10.1 INSTALL THE GLASS PANEL

- TILT AND ALIGN WITH UPPER GASKET GROOVE:** Tilt the glass panel slightly and align the top edge with the groove of the upper gasket.
- SLIDE UPWARDS AND CLEAR BOTTOM TRACK:** Push the glass upward carefully, ensuring it slides securely into the upper track gasket. Lift the glass high enough so that the bottom edge completely clears the bottom track.
- POSITION VERTICALLY AND INSERT INTO BOTTOM GASKET:** Bring the glass into a vertical position, aligning the bottom edge with the groove of the bottom track gasket. Lower the glass gently until it sits securely in the bottom gasket.

Ensure the glass is properly aligned and securely seated before proceeding with the next glass install.

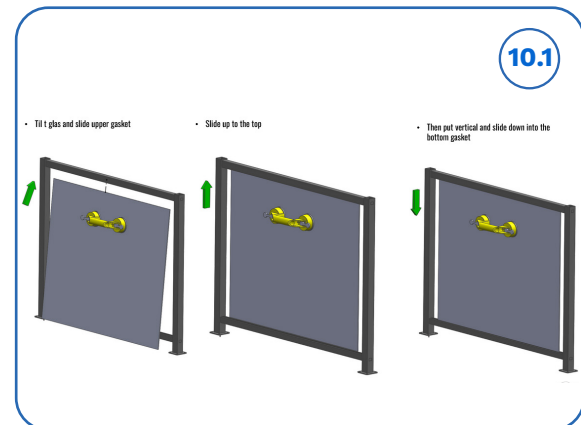

11 INSTALL POST CAP

- Align the post cap with the top of the post.
- Use a rubber mallet to gently tap the post cap into place. Apply light, even pressure to avoid damaging.
- Confirm that the post cap is securely seated and level.

This step completes the finishing touch for the railing assembly!



12 INSTALL HEX CAP COVERS

- PREPARE THE HEX CAP COVERS:** Gather the hex cap covers designed for bolts or screws with 3/8" across-the-flats hex heads.
- SECURE THE COVERS:** Press the hex cap covers firmly onto the bolt or screw heads until they snap into place.

This step provides a clean and finished look while protecting the bolt or screw heads.

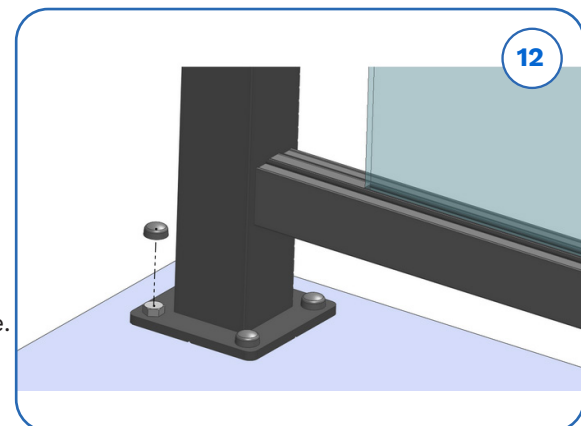

ALUMINUM FRAMED GLASS RAILING INSTALLATION GUIDE

1

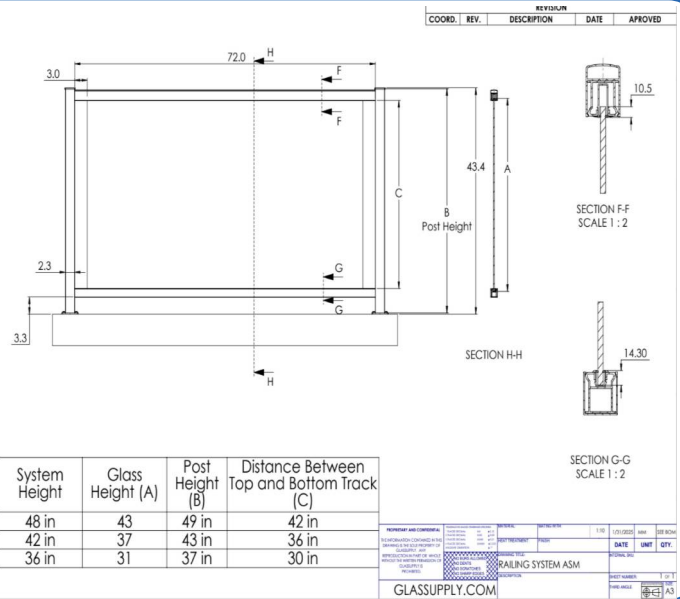
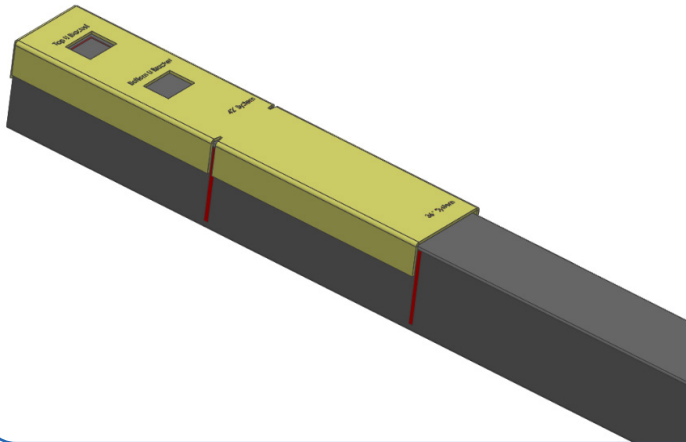

1.1

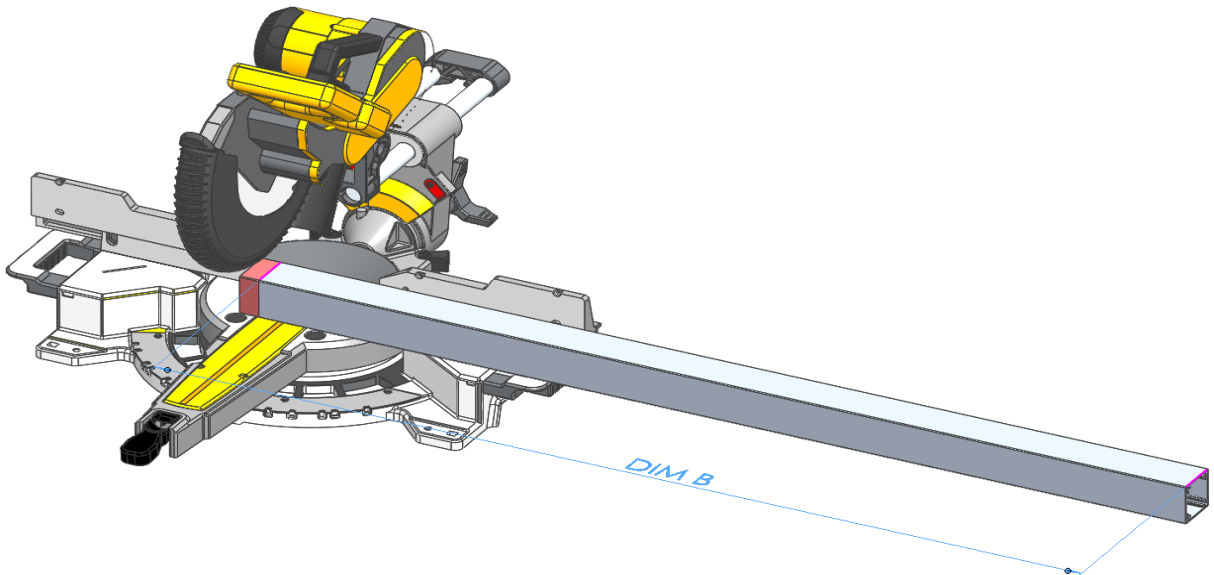

2

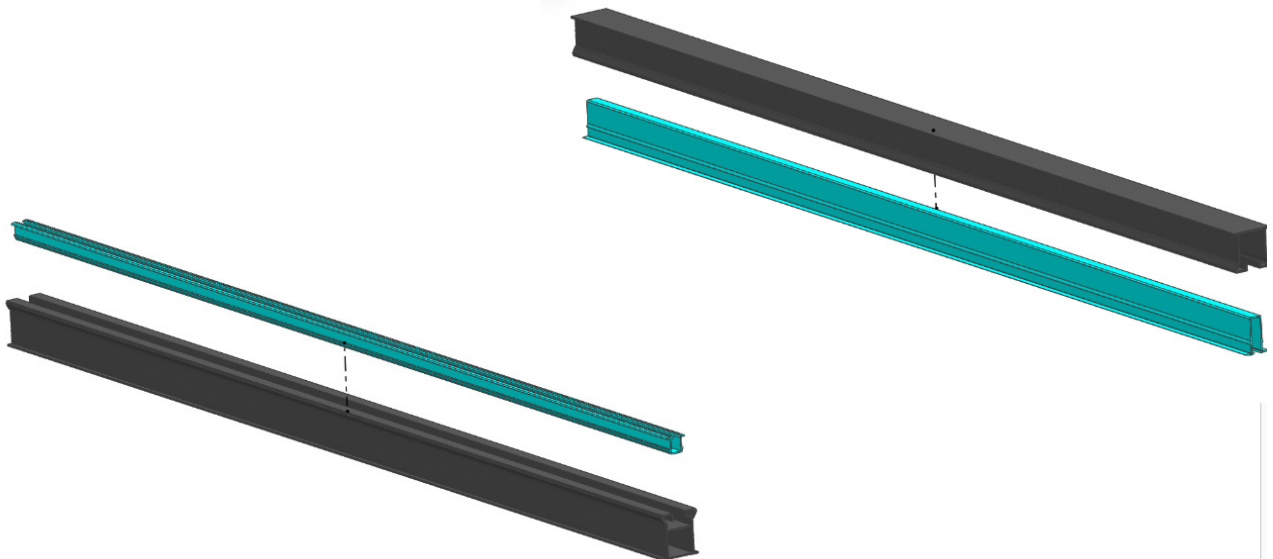

2.1

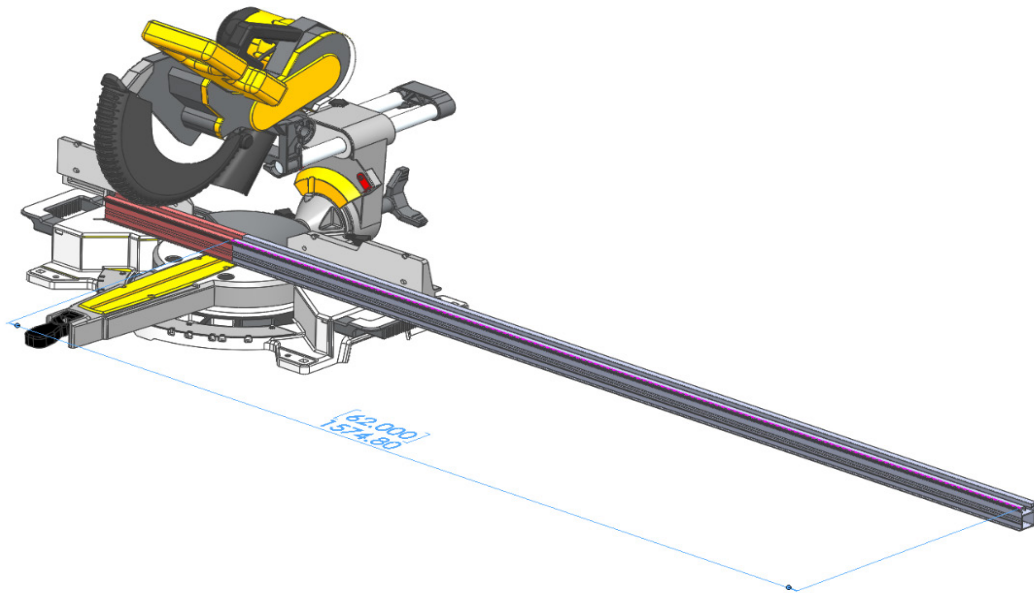

3

it using self tapping screws Part No. 90415A330

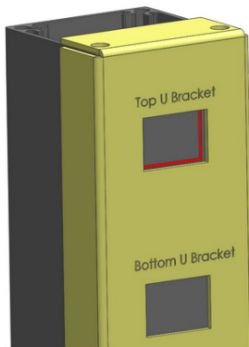

•1

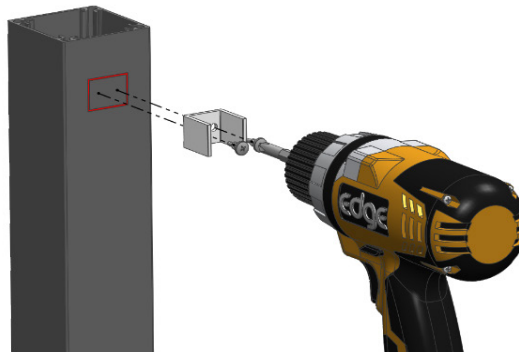

•2

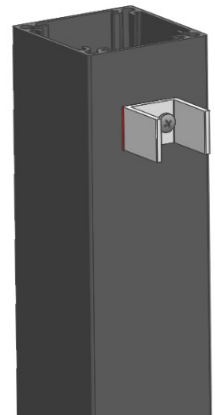

•3

3.1

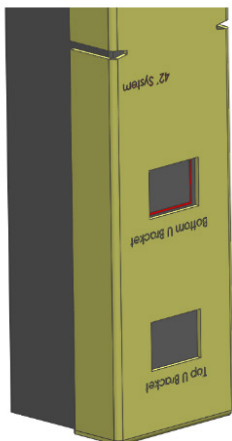

•1

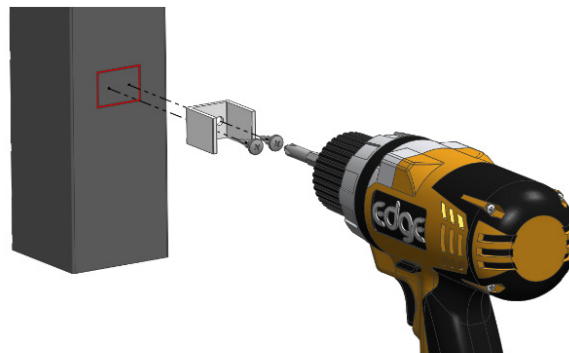

•2

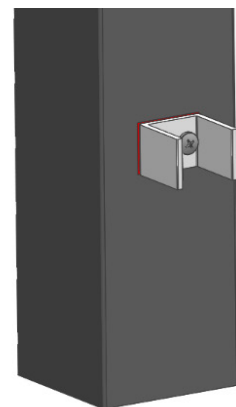

•3

3.2

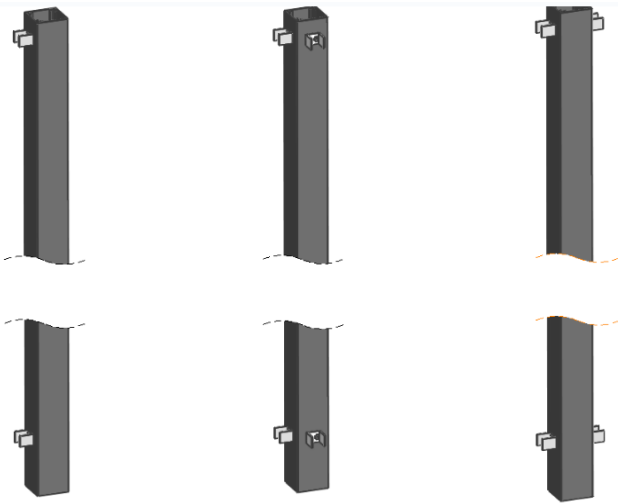

• End Post

• Corner Post

• Middle post

4

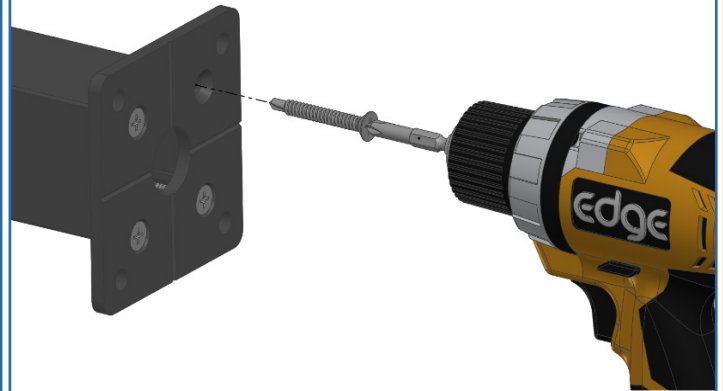

4.1

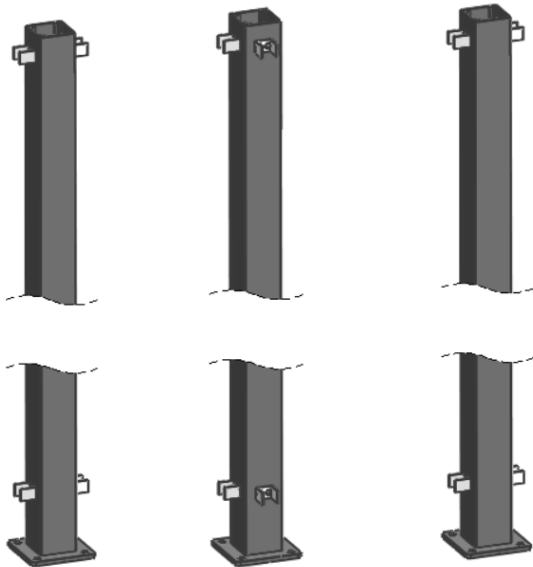

5

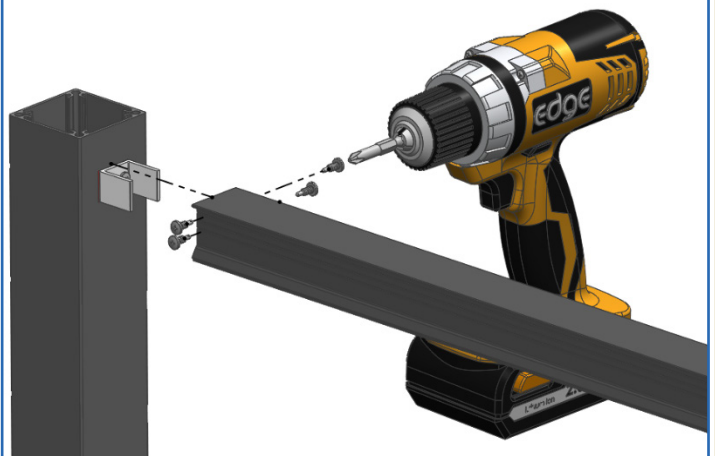

5.1

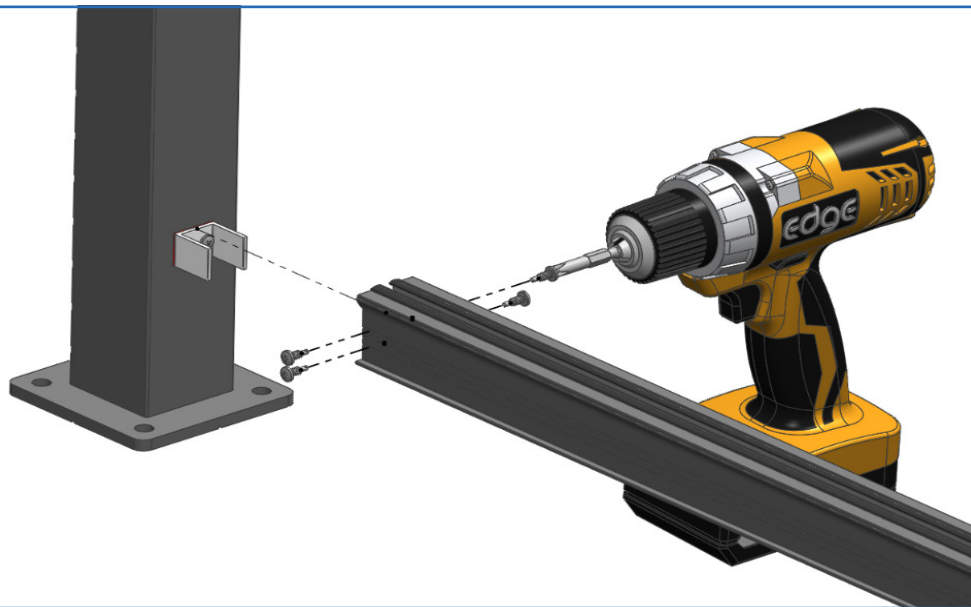

5.2

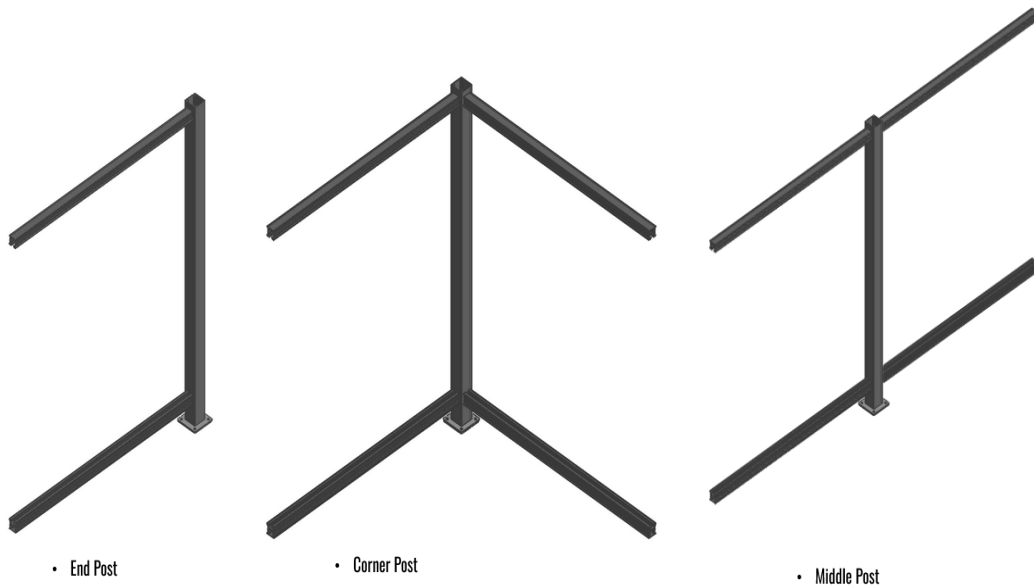

6

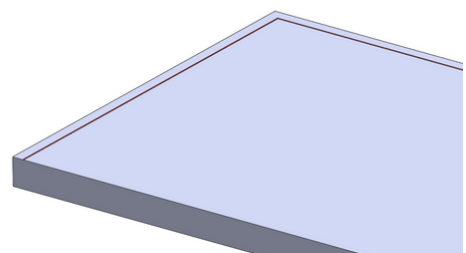
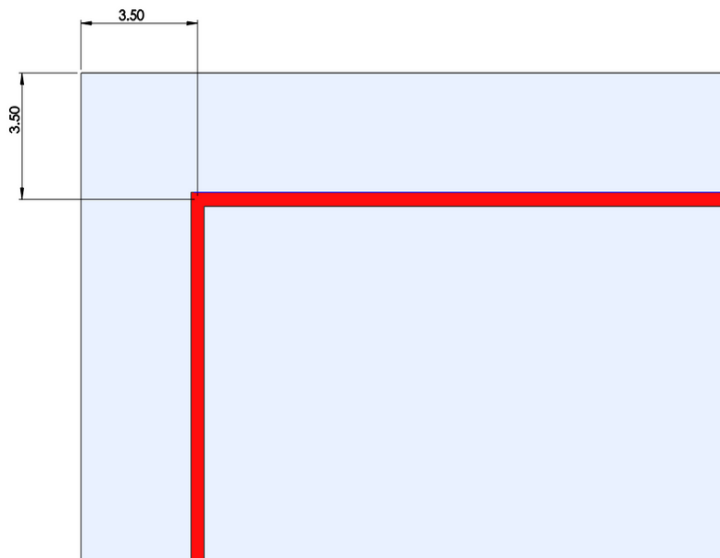

6.1

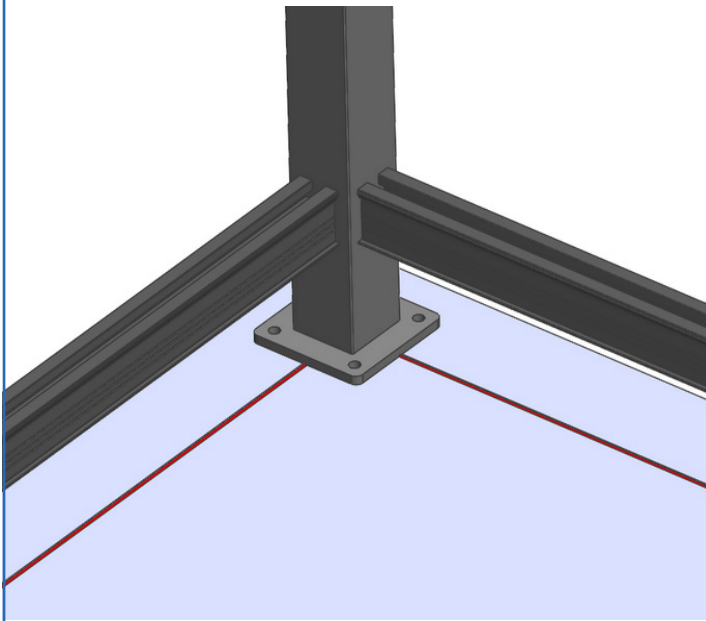

7

Add subsequent post. Make sure is square and use self tapping screws to fix it in place.

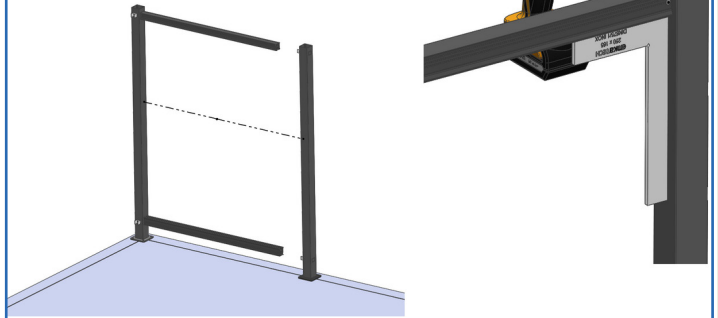

7.1

Add subsequent rails. As shown. Square and screw in place. Repeat step 7.0 and so on.

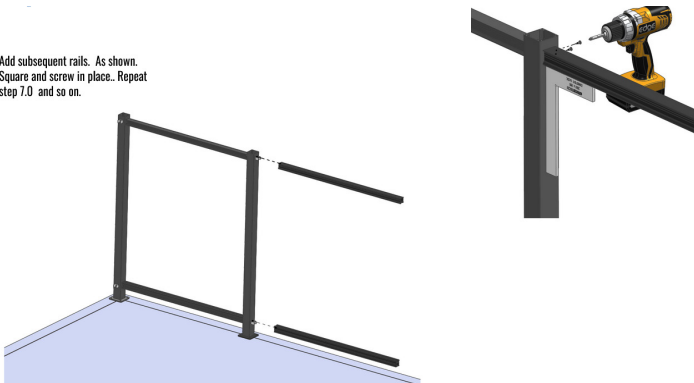

7.2

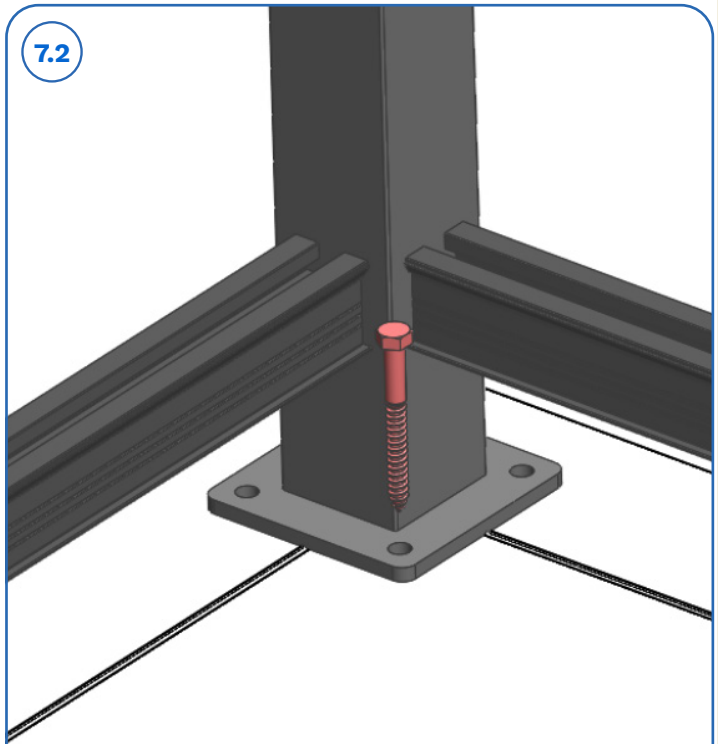

7.3

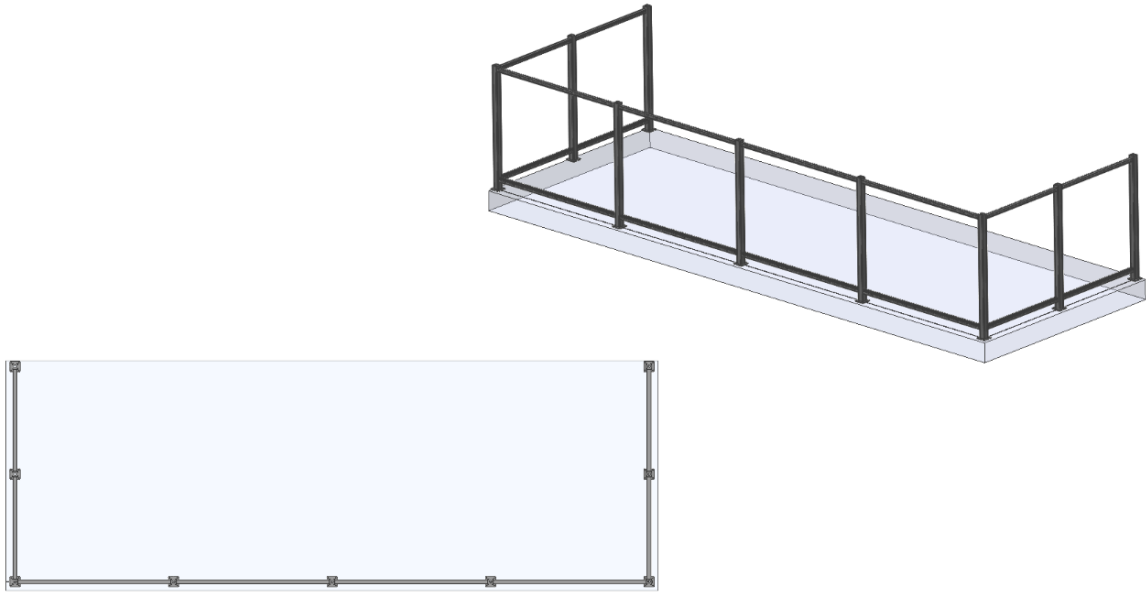

8

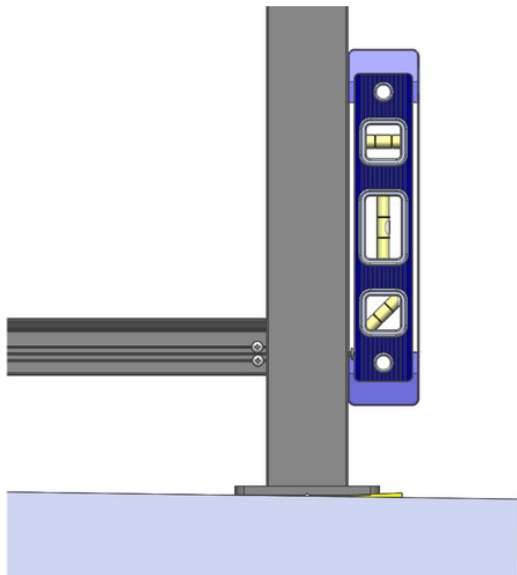

8.1

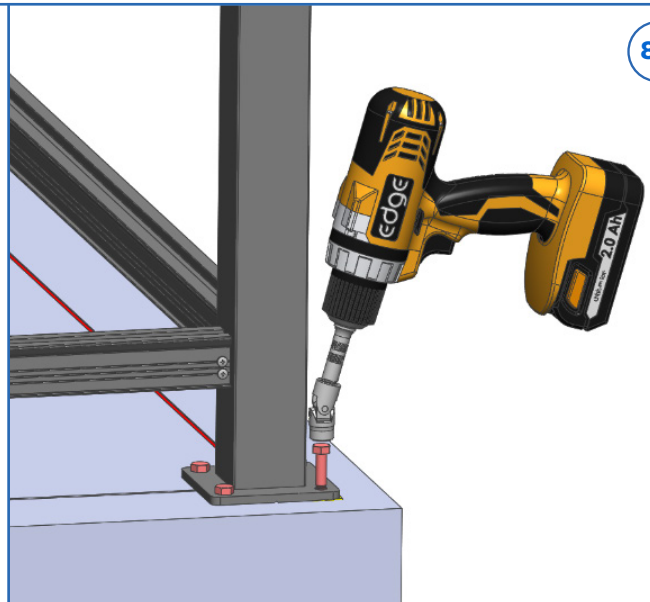

9

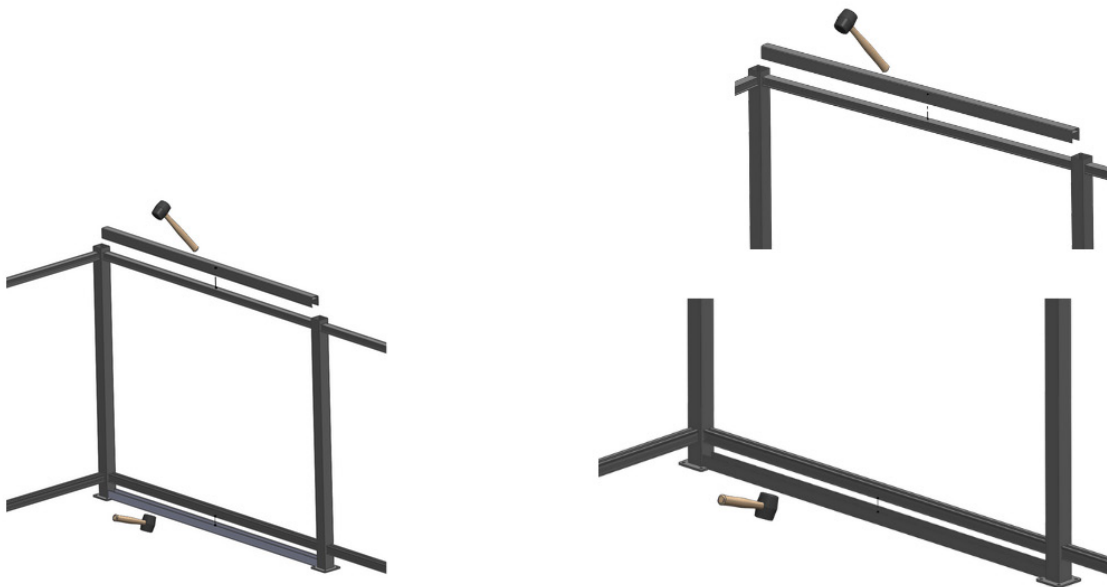

10

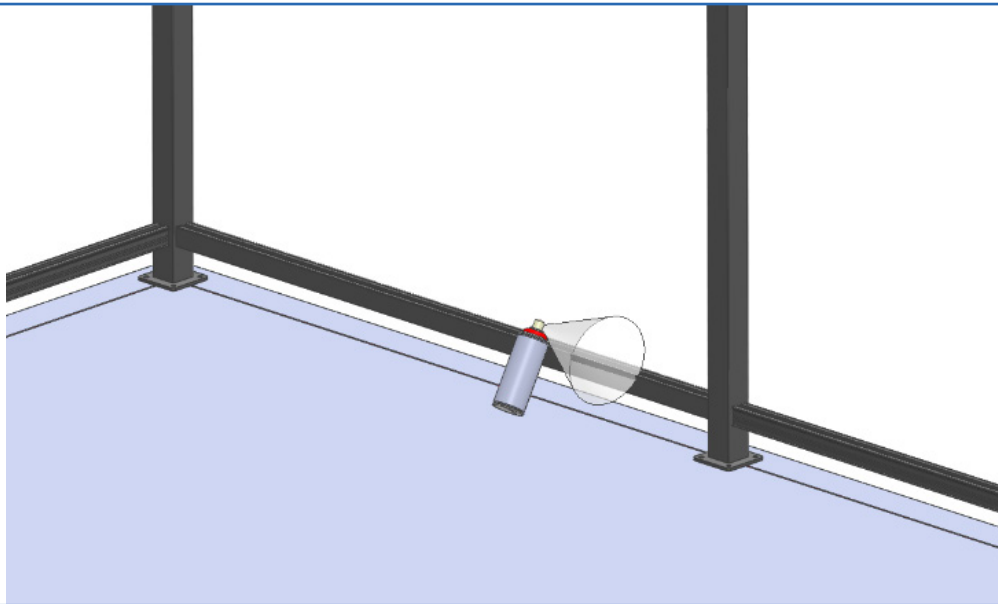

10.1

• Tilt glass and slide upper gasket

• Slide up to the top

• Then put vertical and slide down into the bottom gasket

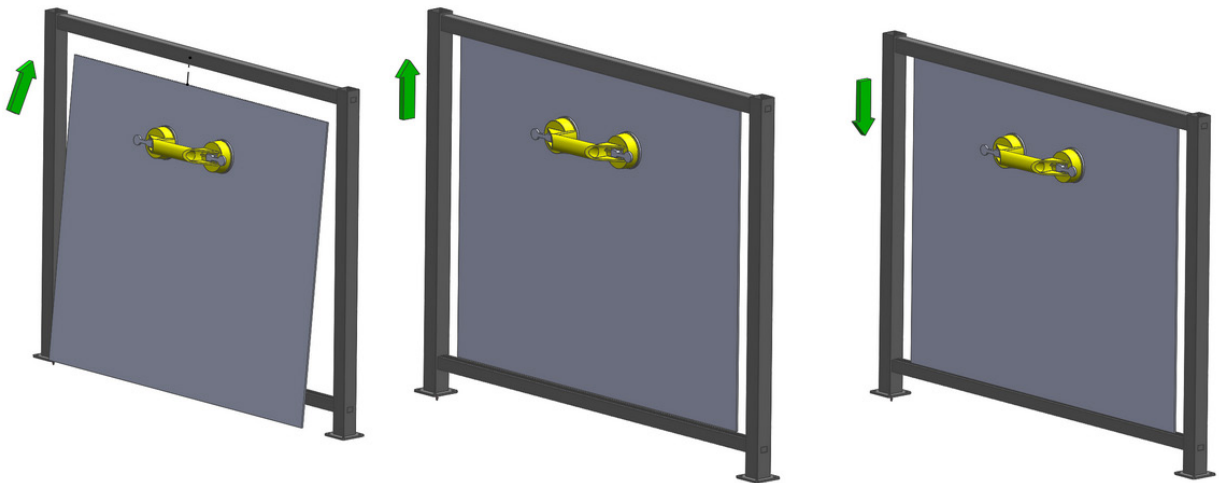

11

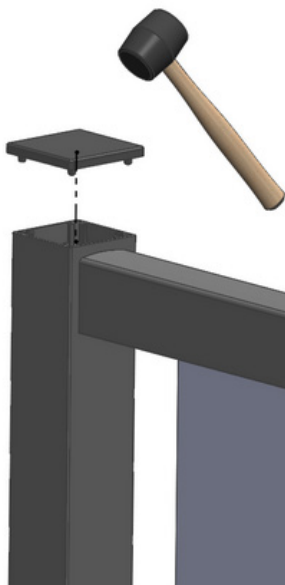

12

